

## V. LANDSCAPE CONCEPT

The conceptual landscape plans for the subject property, as shown on Figures V-A-1 through V-A-14 on the following pages, emphasizes the use of drought tolerant plant species which are best suited for the hot, dry climate of Ontario as well as other plant types that are native or naturalized to the area.

The primary landscape elements identified in this plan include streetscapes, intersections, identity statements, and on-site landscaping treatments. These landscape elements provide project identity and character while providing orientation within the site itself. It should be noted, however, that the plant palettes utilized within the landscape concept may be revised if desired, by the City of Ontario, with equivalent plant materials.

### A. CONCEPTUAL STREETSCAPE PLANS

The conceptual streetscape plans Figures V-A-2 through V-A-14, give visual identity to the Pacific Gate-East Gate Specific Plan area yet remain sensitive to the plant palette previously established and approved in conjunction with the California Commerce Center Specific Plan adjacent to the subject property. More specifically, the plant palette (Figure V-A-16) and streetscape treatments proposed in this plan for those streets bordering both the proposed project and the California Commerce Center carries the theme to the other side of the street as discussed later in this section.

Additionally, as shown in Figure V-A-15, streetscape grading concepts and linear berms are proposed throughout the project within the landscape easement. These berms are to further enhance the landscape character, and to create topographic variation and visual interest to the site.

Finally, shrubs and groundcover are utilized to further articulate the ground plane.

Upon development of individual parcels, each property owner shall be required to install the following streetscape treatments:

#### 1. Major and Standard Arterials (Airport Drive, Jurupa Street)

Large, predominantly evergreen, canopy trees, formally planted, and equally spaced, are proposed for the southern side of Airport Drive between Wanamaker and Rochester Avenues as stipulated by the California Commerce Center's conceptual landscape plan, Exhibit 34, page 57, of that document. Random groupings of large canopy trees with a background of additional random groupings of conical evergreen trees will line Jurupa Street. Figures V-A-2 through V-A-5 of this text show conceptual planting schemes for Airport Drive and Jurupa Street.

#### 2. Local Industrial Streets

Local industrial streets are expressed with a formal planting of equally spaced or, in certain situations, an informal, random planting, of medium evergreen/deciduous canopy or conical trees (see Figures V-A-6 through V-A-14). Planting schemes and plant palette utilized carry over the previously approved and installed landscape themes within the adjacent California Commerce Center Specific Plan area.

# CONCEPTUAL LANDSCAPE PLAN

FIGURE  
V-A-1

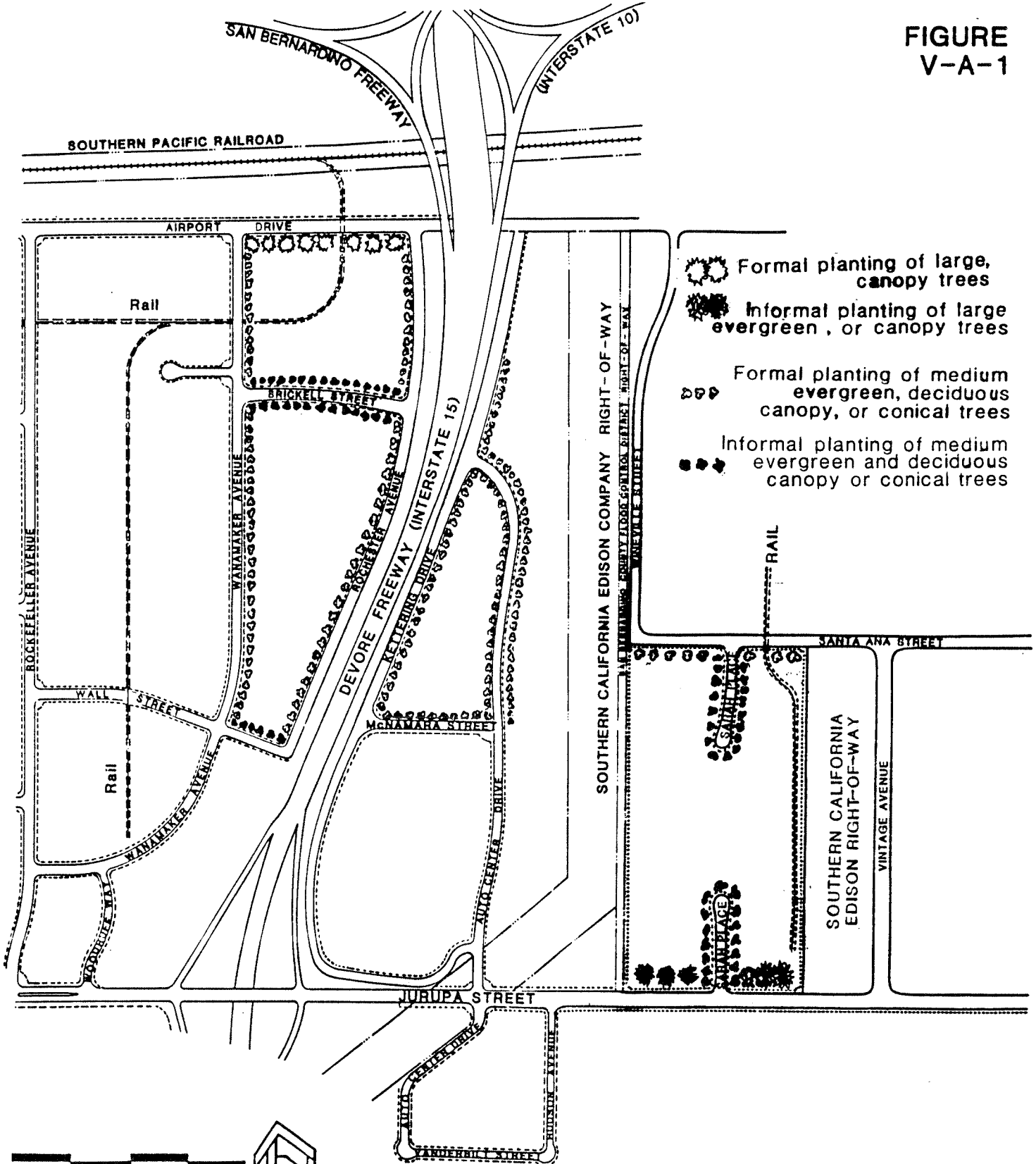

  
**PLANNING NETWORK**  
 Land Planning and Design • Policy Analysis  
 Environmental Studies • Project Management  
 2949 East G Street, Suite 105  
 Ontario, CA 91764  
 Tel (714) 945-2738

**PACIFIC GATE - EAST GATE SPECIFIC PLAN**  
**SANTA FE PACIFIC REALTY CORPORATION**

# STREETSCAPE MAJOR ARTERIAL

(Jurupa Street)

FIGURE  
V-A-2

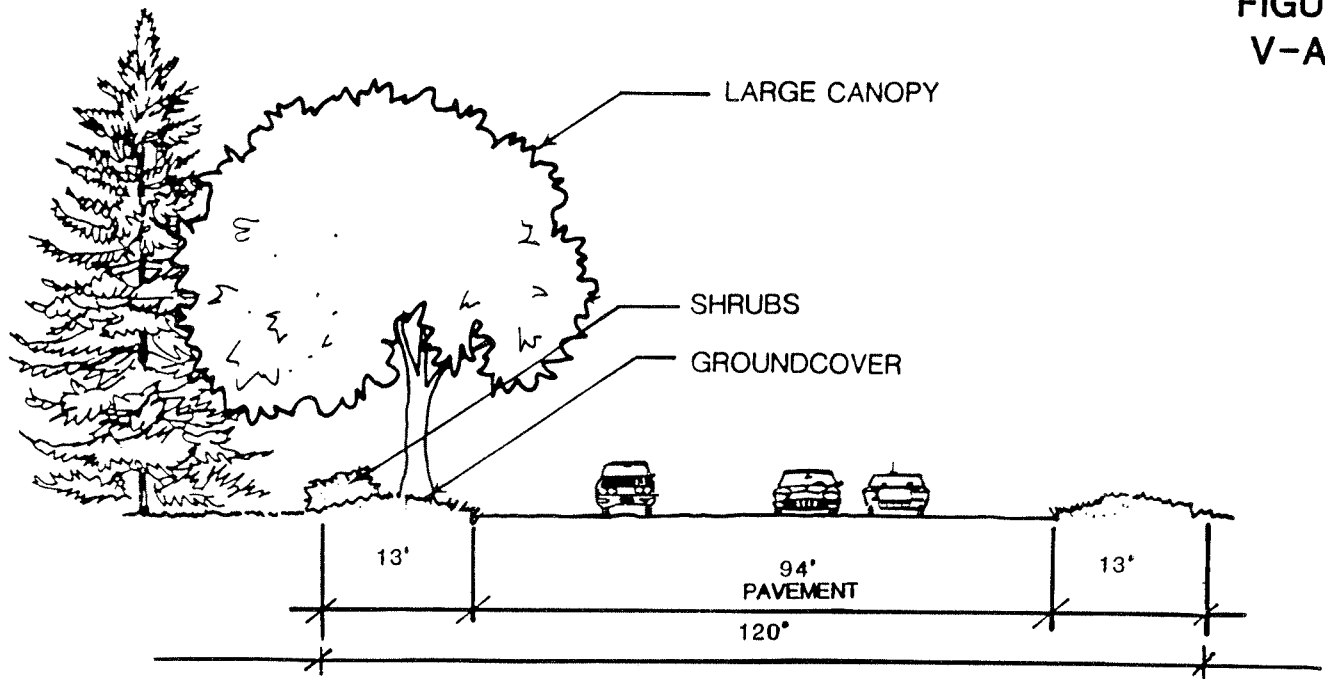

SECTION  
(Not to Scale)

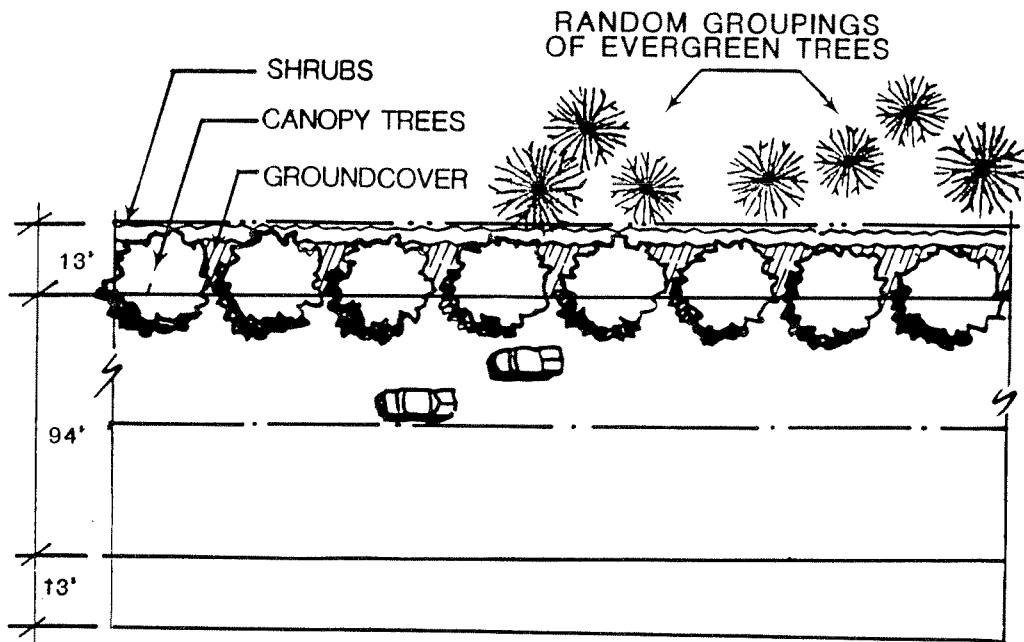

CONCEPTUAL PLAN  
(Not to Scale)

PACIFIC GATE - EAST GATE SPECIFIC PLAN  
SANTA FE PACIFIC REALTY CORPORATION

# STREETSCAPE MAJOR ARTERIAL

(Jurupa Street)

FIGURE  
V-A-3

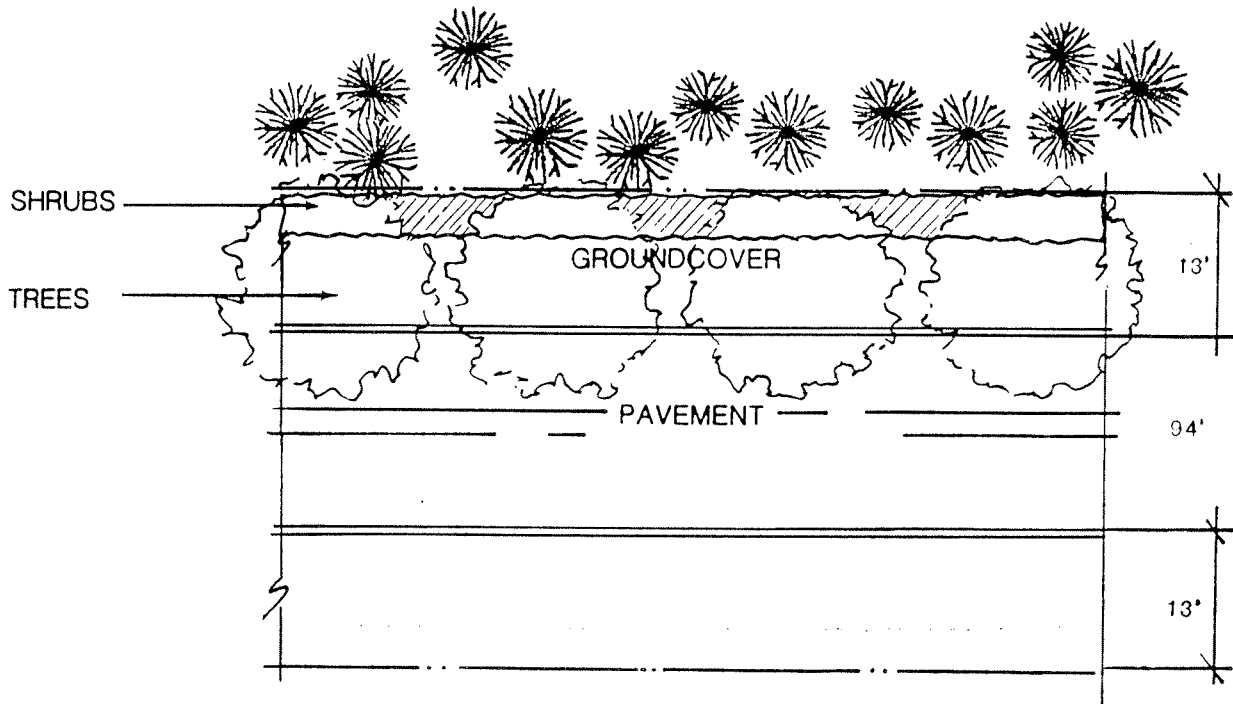

CONCEPTUAL PLANTING PLAN  
( Not to scale )

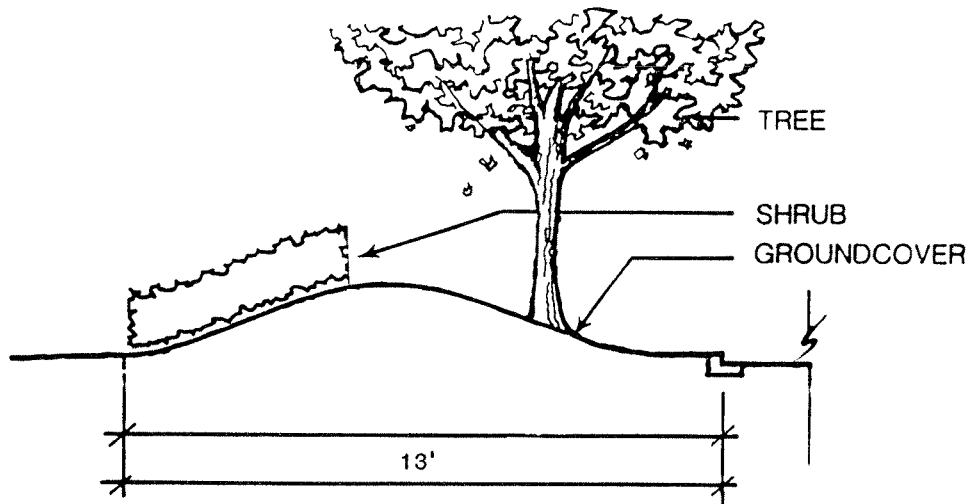

CONCEPTUAL PLANTING SECTION  
( Not to scale )

LANDSCAPE EASEMENT

PACIFIC GATE - EAST GATE SPECIFIC PLAN  
SANTA FE PACIFIC REALTY CORPORATION

# STREETSCAPE STANDARD ARTERIAL

( Airport Drive )

FIGURE  
V-A-4

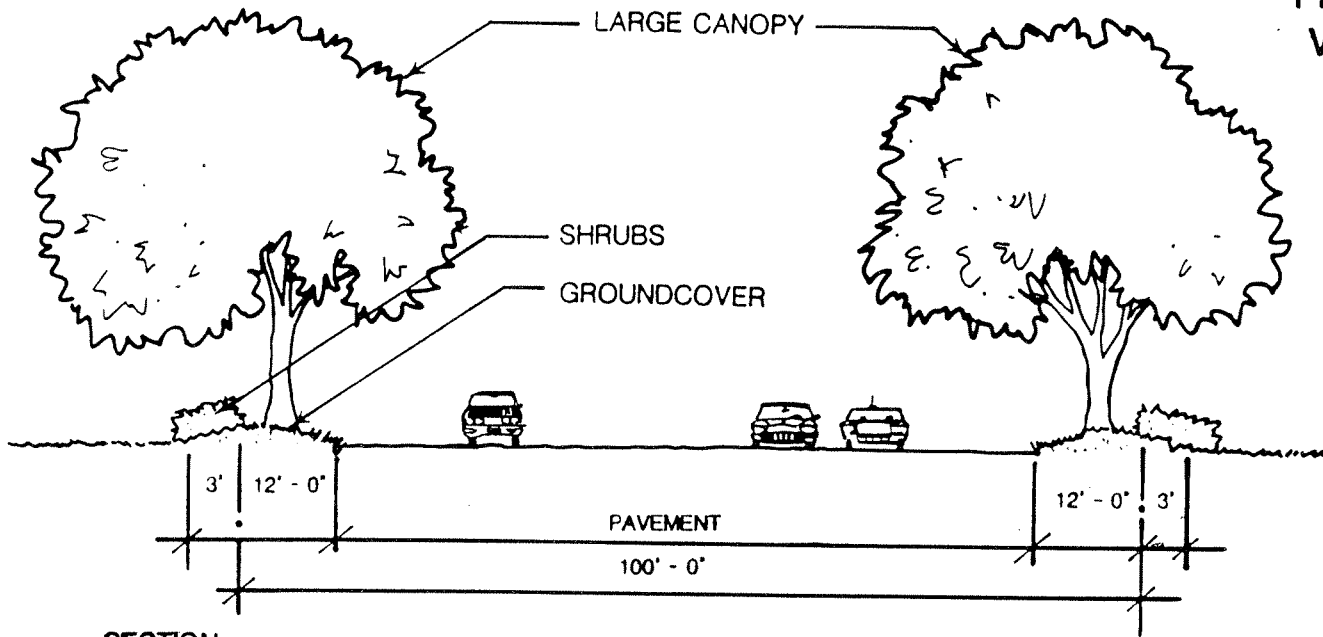

SECTION  
(Not to Scale)

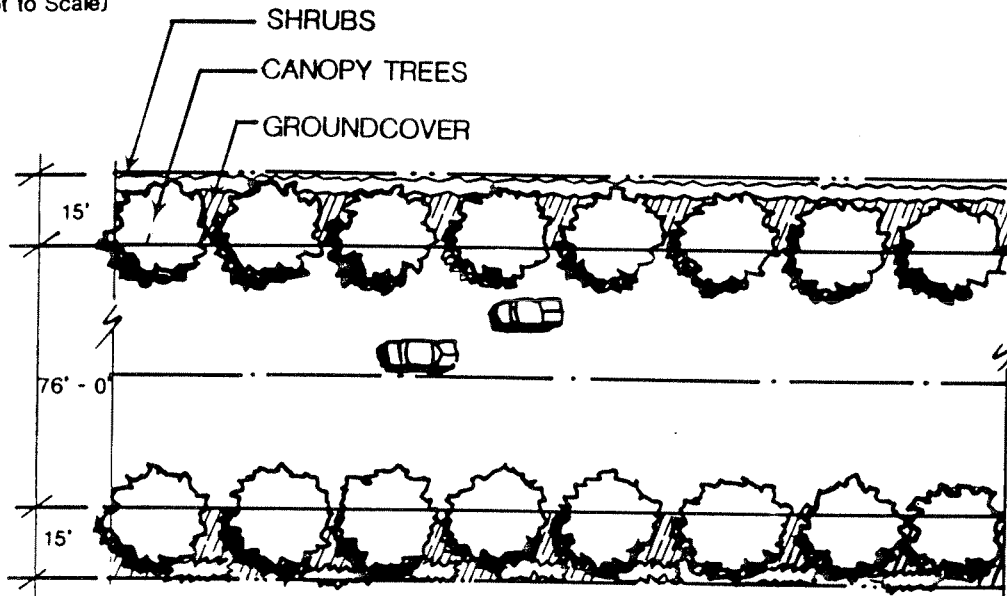

CONCEPTUAL PLAN  
(Not to Scale)

# STREETSCAPE STANDARD ARTERIAL

(Airport Drive)

FIGURE  
V-A-5

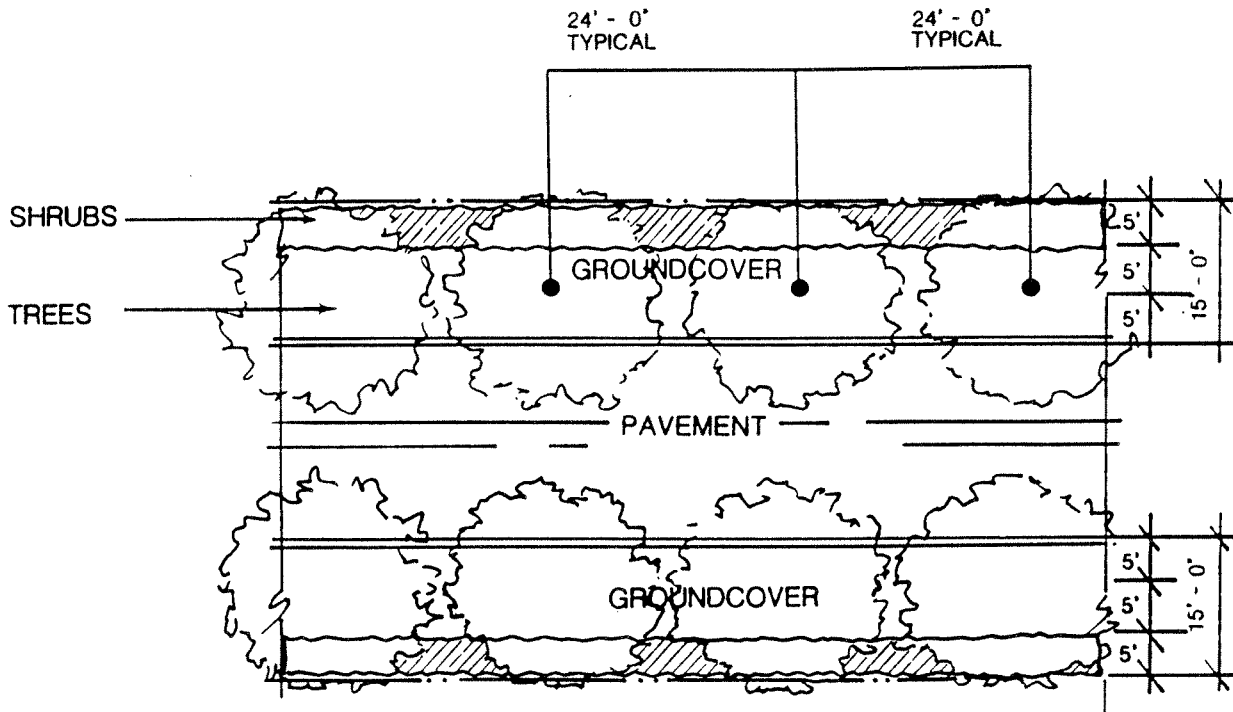

CONCEPTUAL PLANTING PLAN  
( Not to scale )

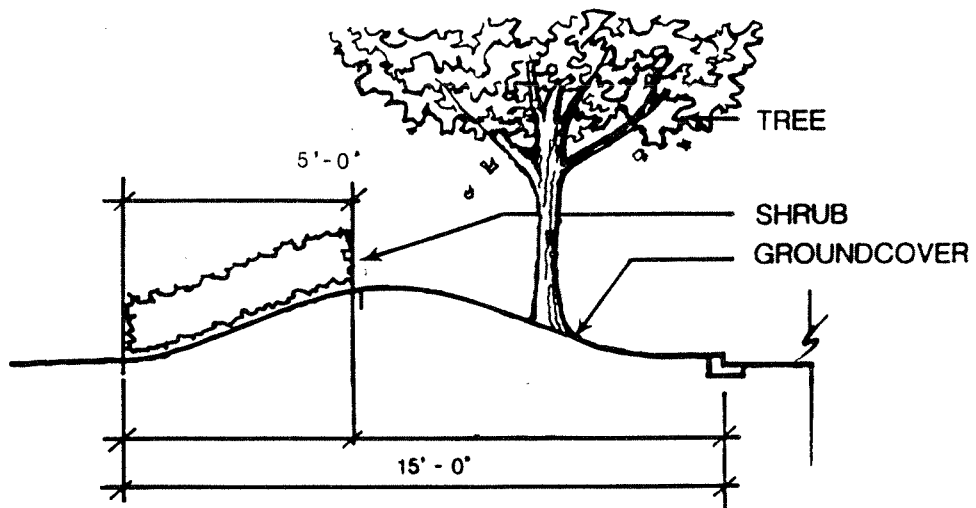

CONCEPTUAL PLANTING SECTION  
( Not to scale )

LANDSCAPE EASEMENT

PACIFIC GATE - EAST GATE SPECIFIC PLAN  
SANTA FE PACIFIC REALTY CORPORATION

# STREETSCAPE LOCAL INDUSTRIAL STREETS

Kettering Drive (North of Auto Center Drive)

FIGURE  
V-A-6

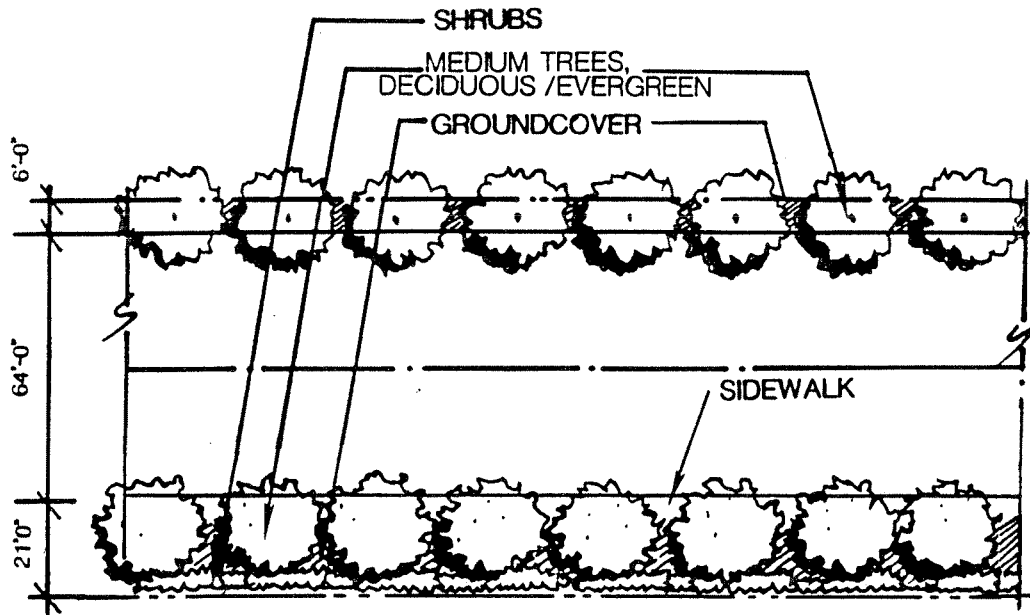
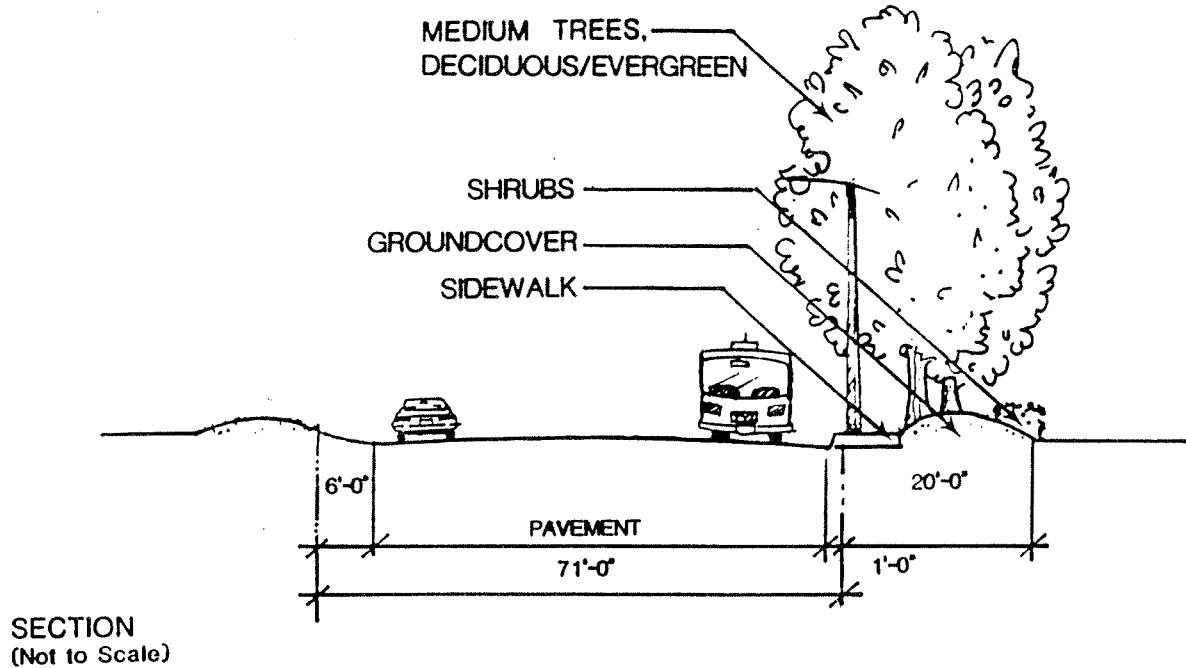

PACIFIC GATE - EAST GATE SPECIFIC PLAN  
SANTA FE PACIFIC REALTY CORPORATION

# STREETSCAPE LOCAL INDUSTRIAL STREETS

Kettering Drive (South of Auto Center Drive)

FIGURE  
V-A-7

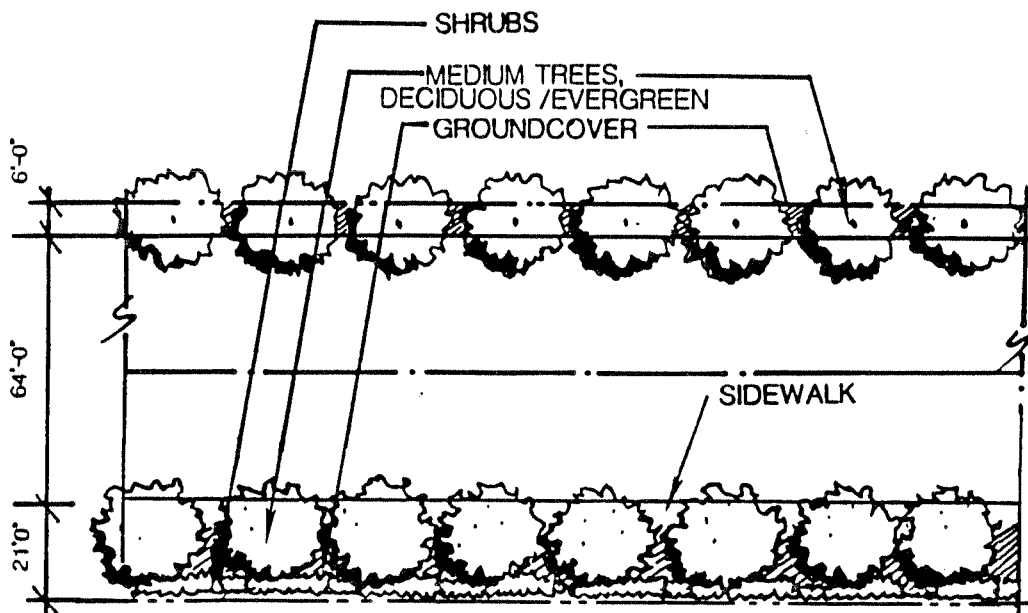
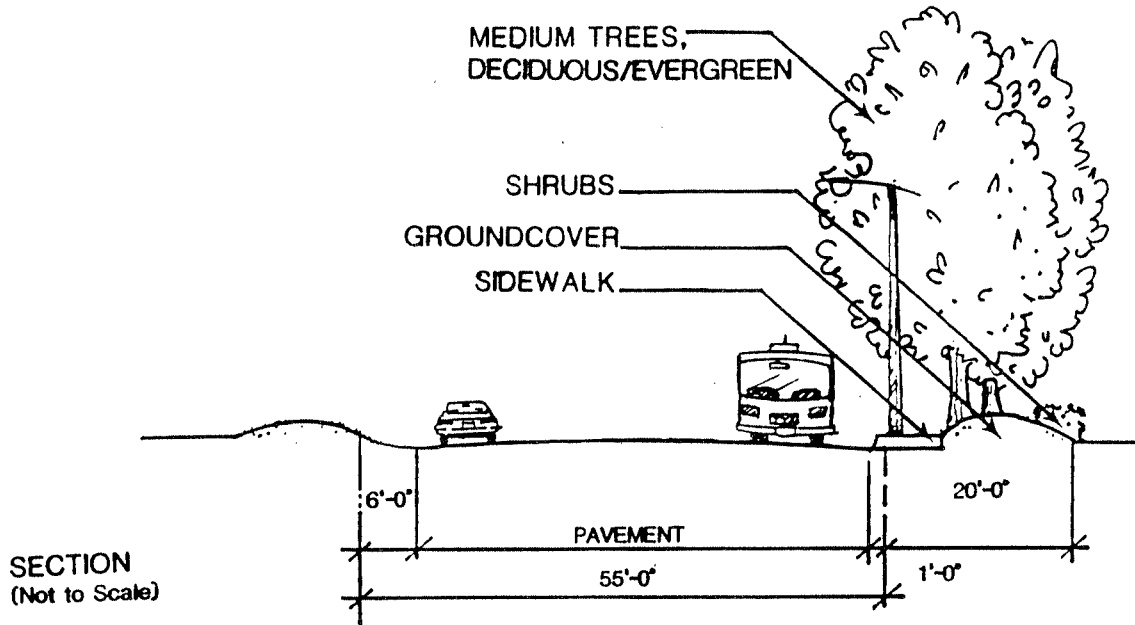

PACIFIC GATE - EAST GATE SPECIFIC PLAN  
SANTA FE PACIFIC REALTY CORPORATION



# STREETSCAPE LOCAL INDUSTRIAL STREETS

Kettering Drive

FIGURE  
V-A-8

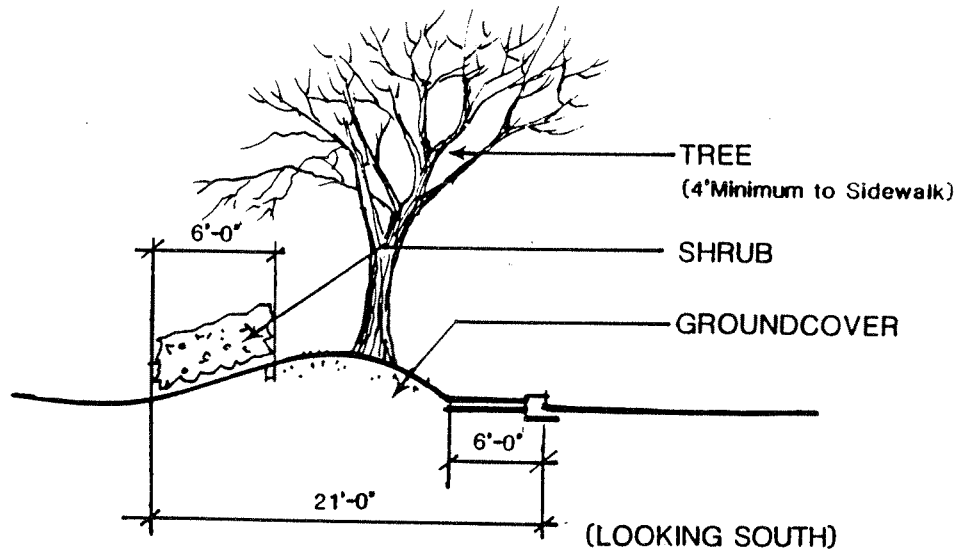
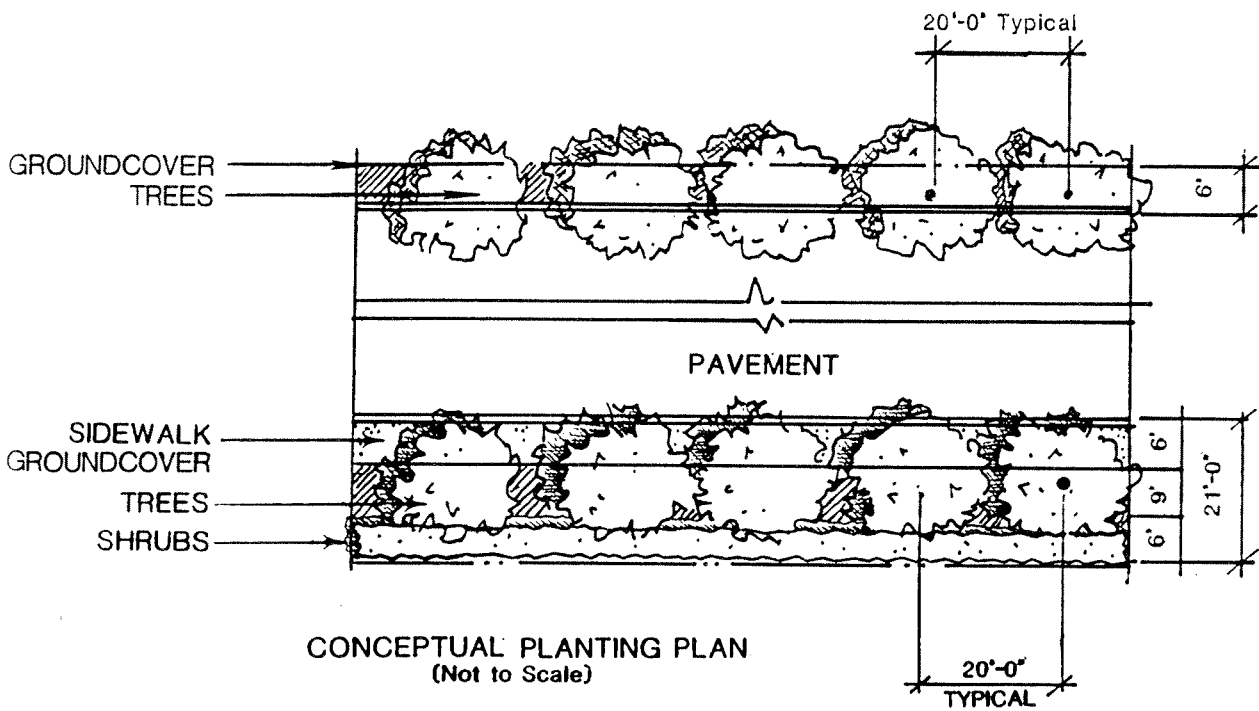

CONCEPTUAL PLANTING SECTION  
(Not to Scale)

PACIFIC GATE - EAST GATE SPECIFIC PLAN  
SANTA FE PACIFIC REALTY CORPORATION

# STREETSCAPE LOCAL INDUSTRIAL STREET

Rochester Avenue

FIGURE  
V-A-9

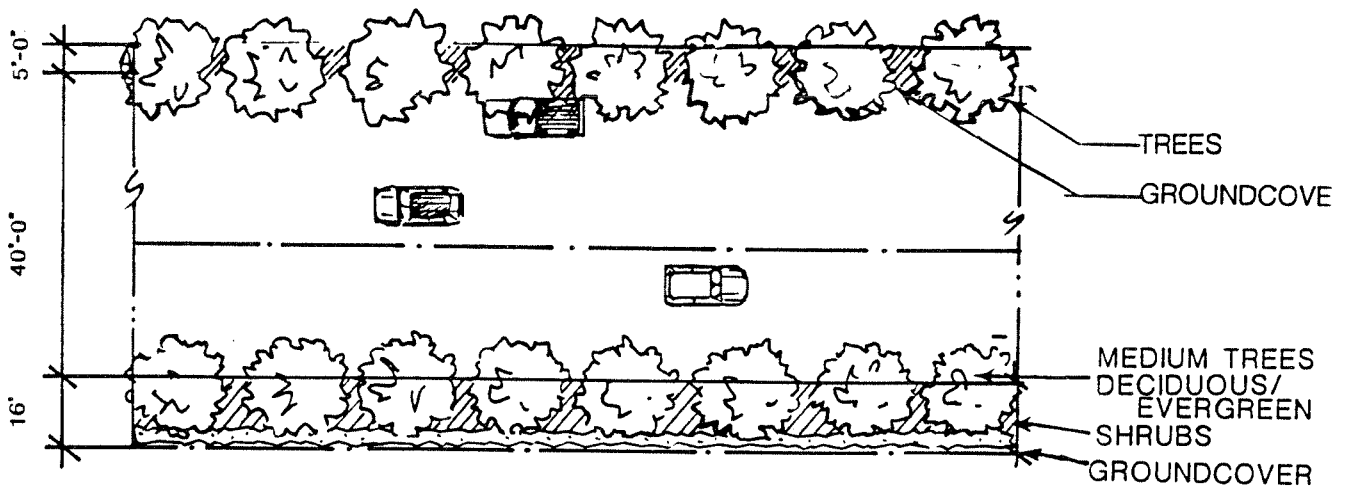
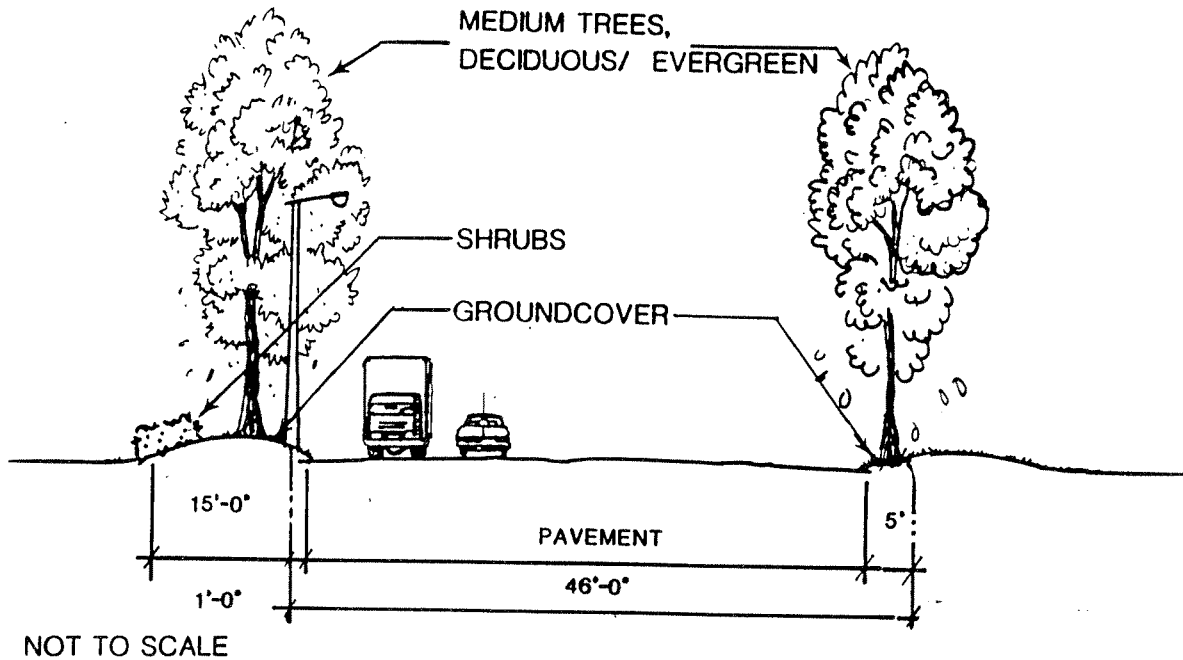

PACIFIC GATE - EAST GATE SPECIFIC PLAN  
SANTA FE PACIFIC REALTY CORPORATION

# STREETSCAPE LOCAL INDUSTRIAL STREET

Brickell Street

FIGURE  
V-A-10

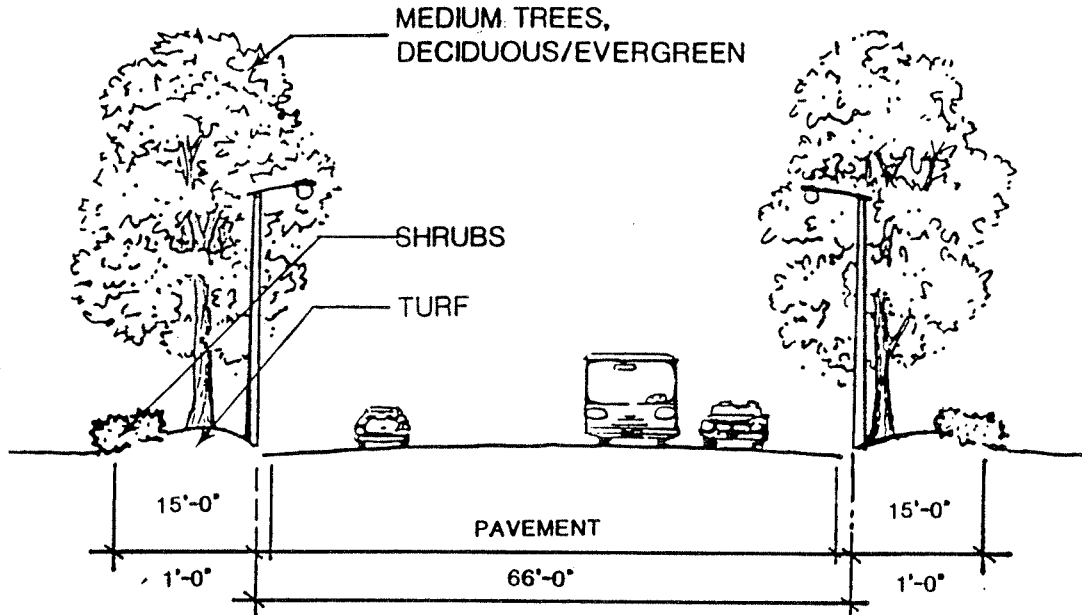

SECTION  
(Not to Scale)

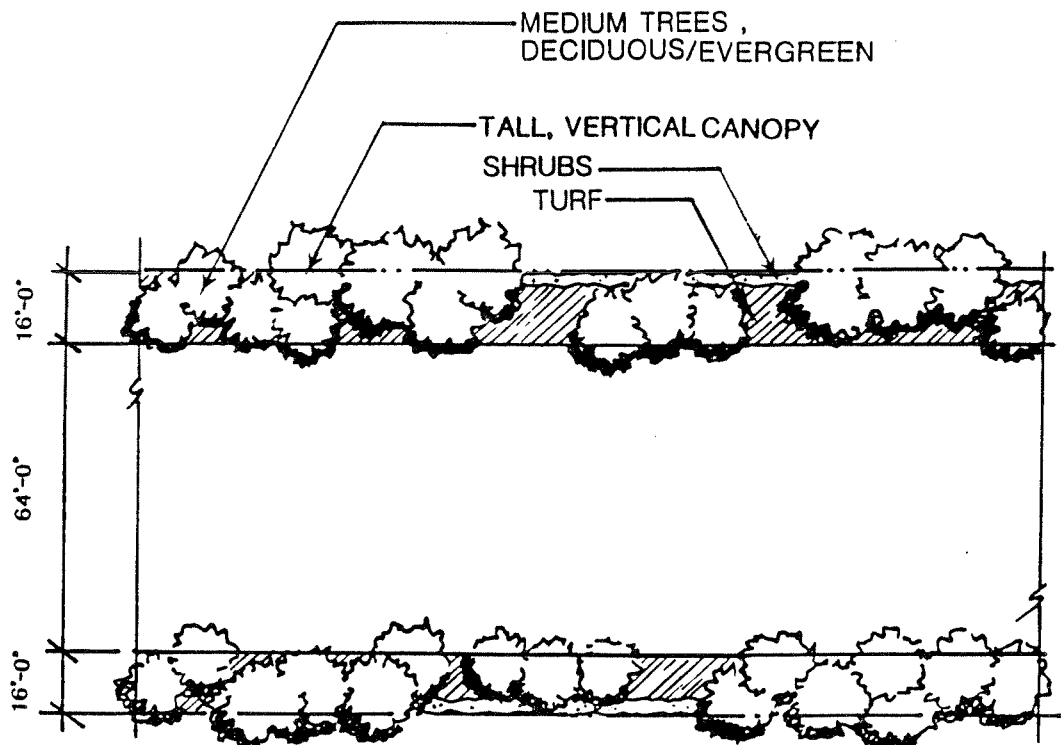

CONCEPTUAL PLAN  
(Not to Scale)

# STREETSCAPE LOCAL INDUSTRIAL STREET

Wall Street

FIGURE  
V-A-11

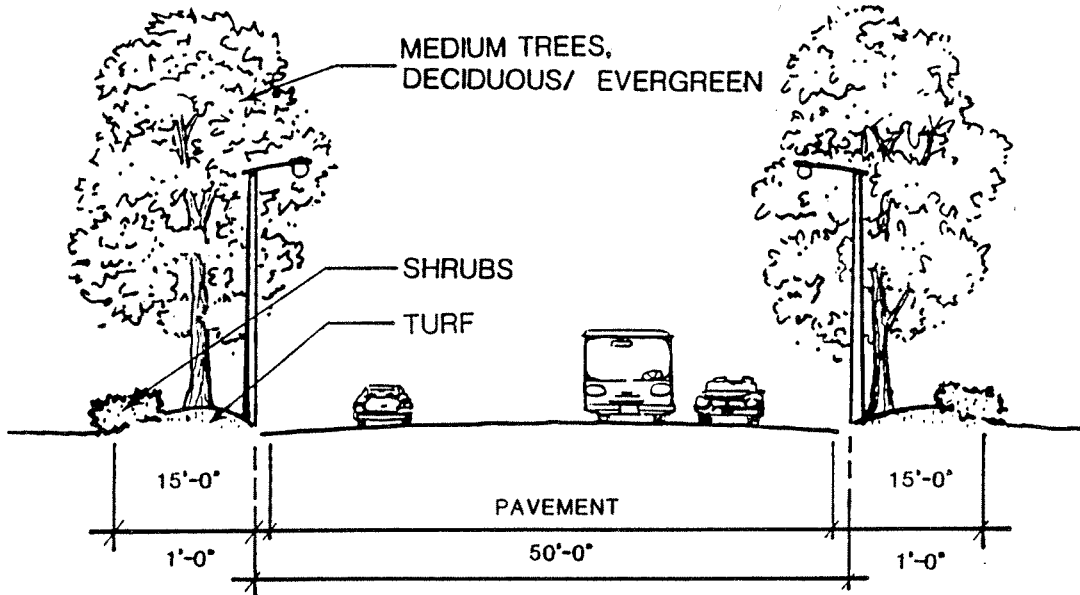

CONCEPTUAL PLAN  
(Not to Scale)

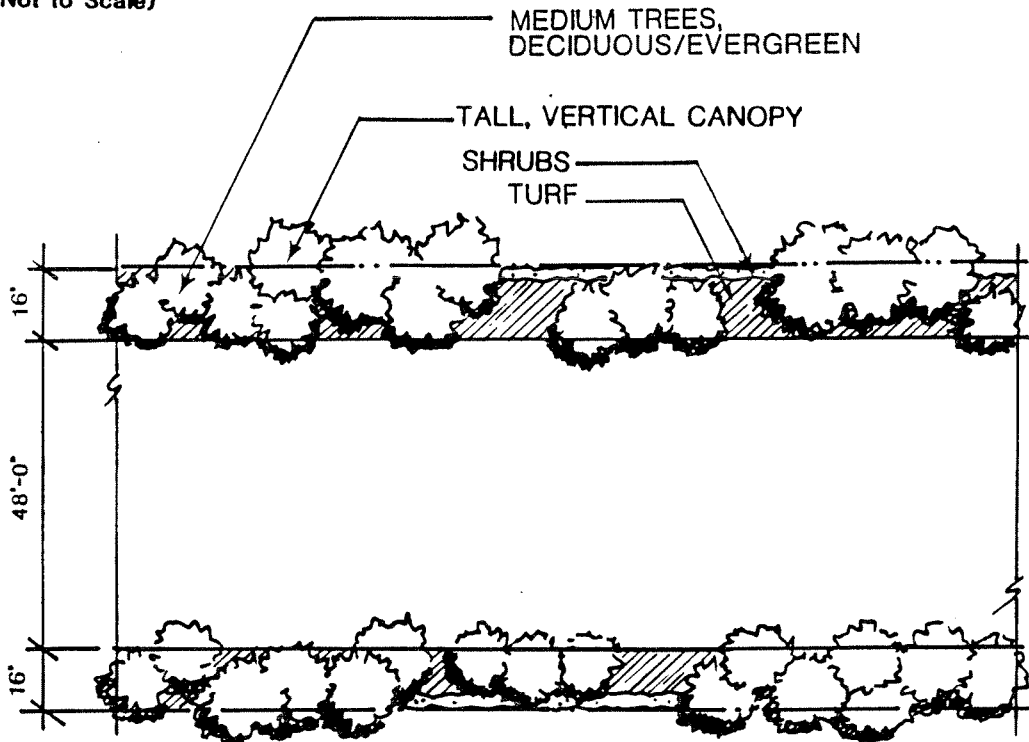

SECTION  
(Not to Scale)

PACIFIC GATE - EAST GATE SPECIFIC PLAN  
SANTA FE PACIFIC REALTY CORPORATION

# STREETSCAPE LOCAL INDUSTRIAL STREETS

McNamara Street  
Auto Center Drive  
Wanamaker Avenue

FIGURE  
V-A-12

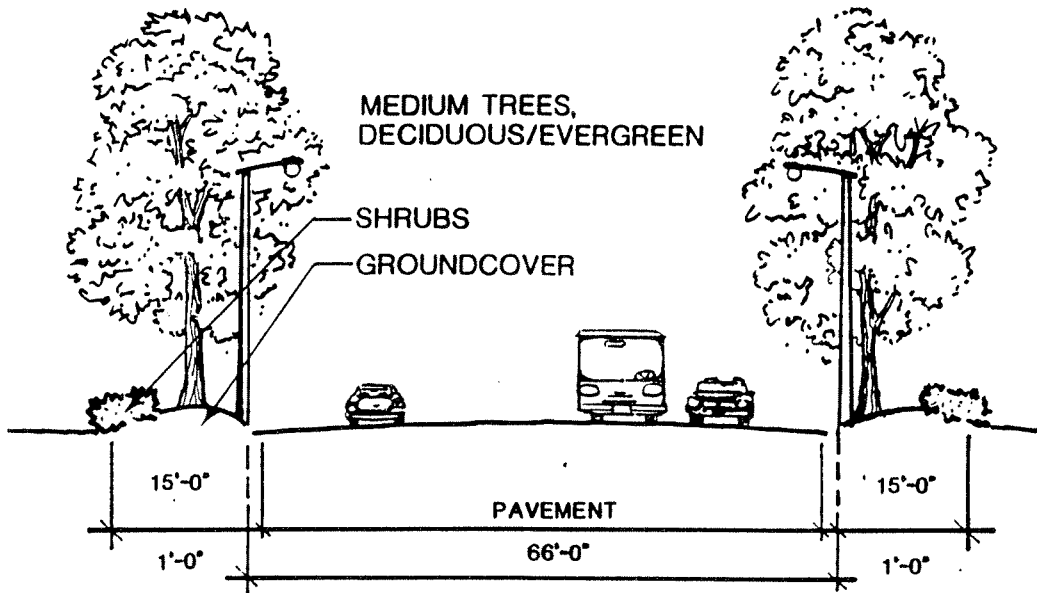

SECTION  
(Not to Scale)

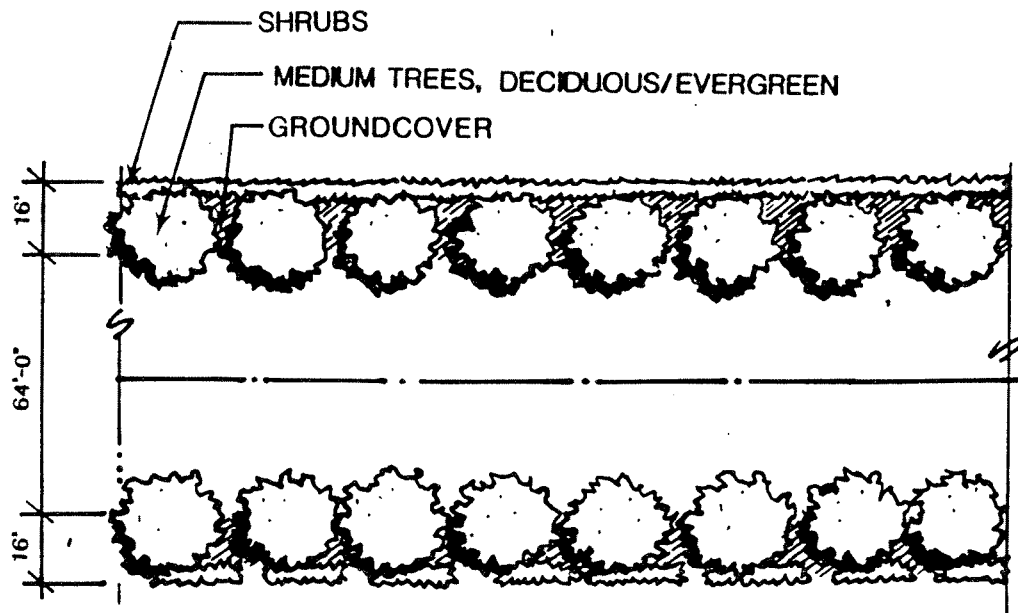

CONCEPTUAL PLAN  
(Not to Scale)

# STREETSCAPE LOCAL INDUSTRIAL CUL-DE-SACS

Sarah Place North and South

FIGURE  
V-A-13

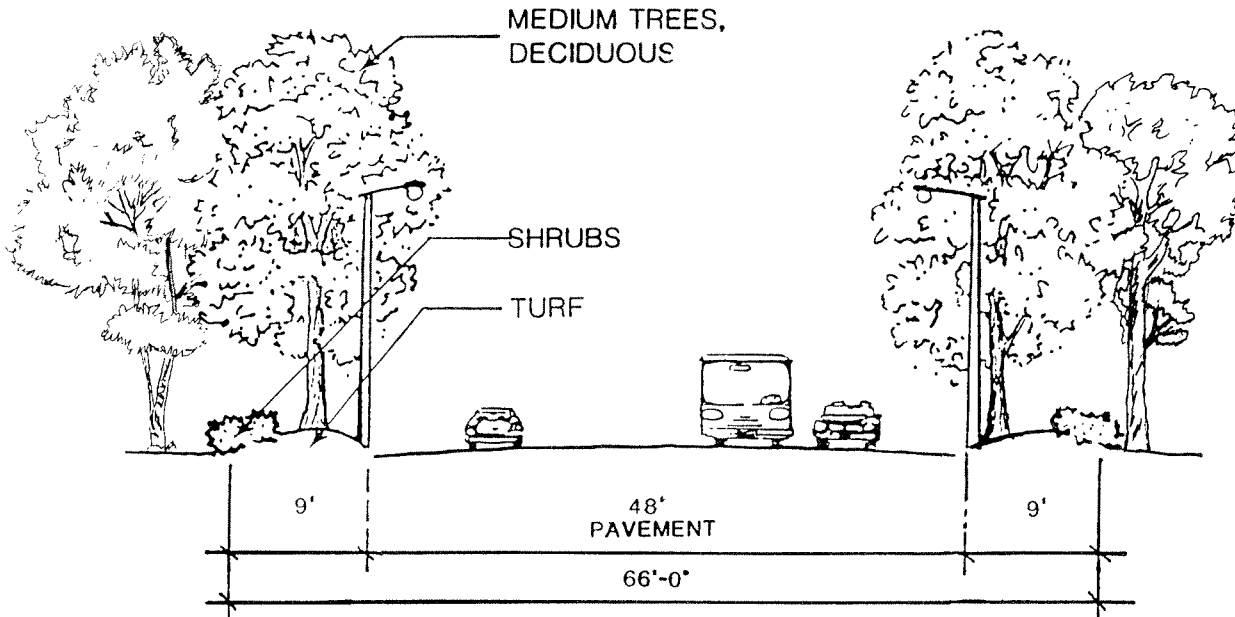

SECTION  
(Not to Scale)

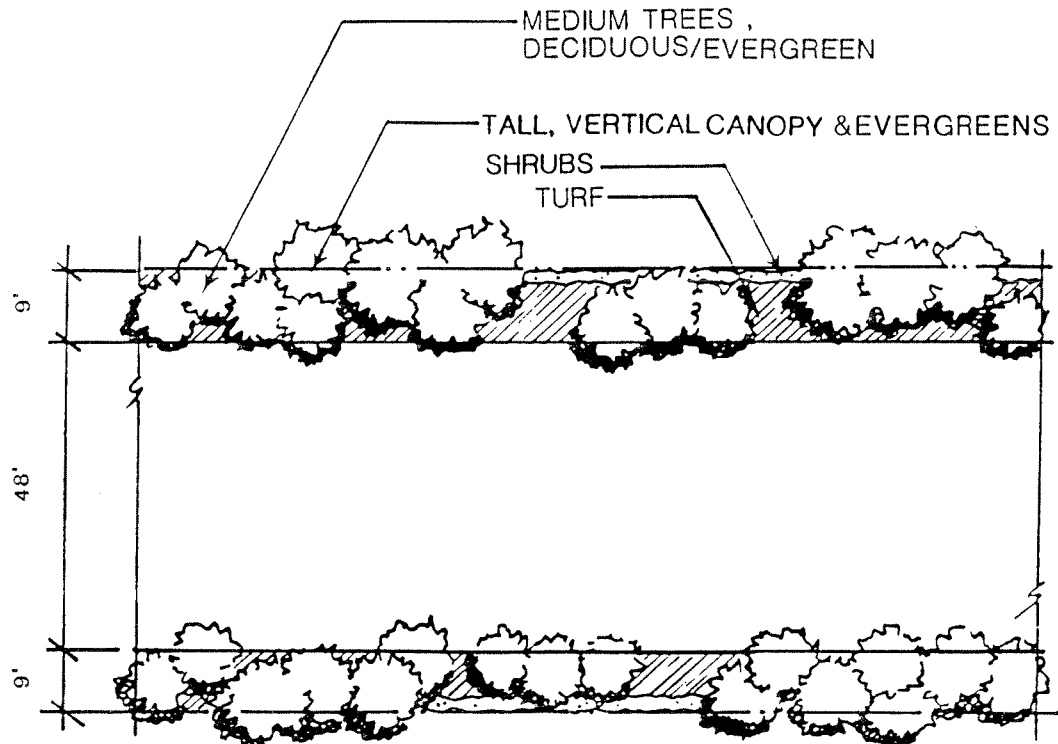

CONCEPTUAL PLAN  
(Not to Scale)

PACIFIC GATE - EAST GATE SPECIFIC PLAN  
SANTA FE PACIFIC REALTY CORPORATION



# STREETSCAPE LOCAL INDUSTRIAL STREETS

Auto Center Drive  
Brickell Street  
Wanamaker Ave.

Wall Street  
Rochester Ave.  
McNamara Street

FIGURE  
V-A-15

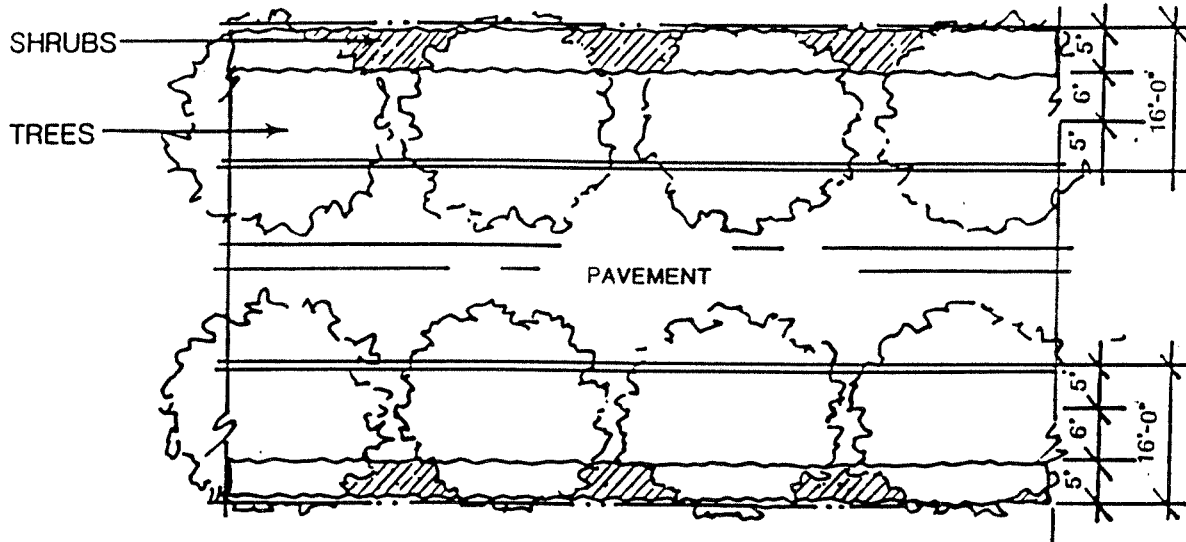

CONCEPTUAL PLANTING PLAN  
(Not to Scale)

NOTE:

1. Brickell and Wall Sts. to incorporate the random planting of street trees, and turf for groundcover as shown on conceptual plan
2. All informal planting arrangements to be of quantities equivalent to 20' on-center spacings.

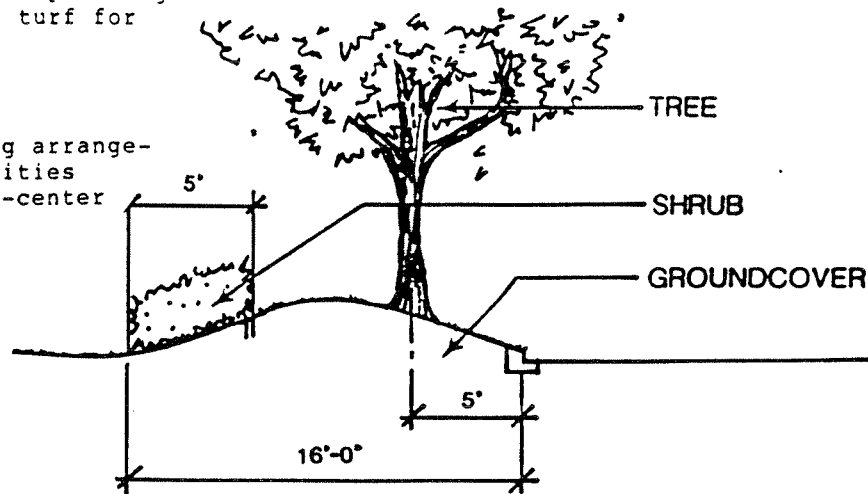

CONCEPTUAL PLANTING PLAN  
(Not to Scale)



# STREETSCAPE GRADING

FIGURE  
V-A-16

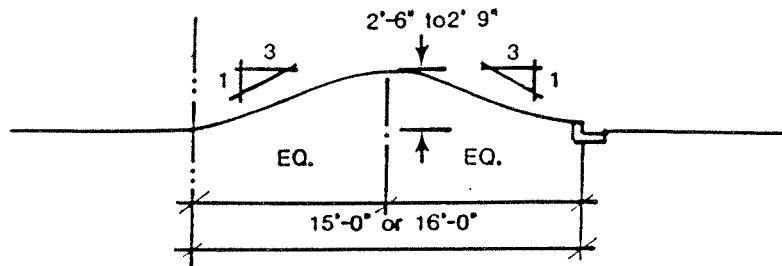

21' LANDSCAPE EASEMENT

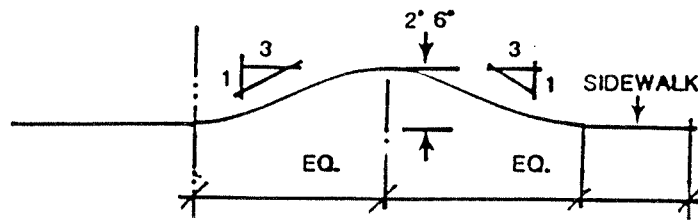

13', 15' and 16' LANDSCAPE EASEMENT

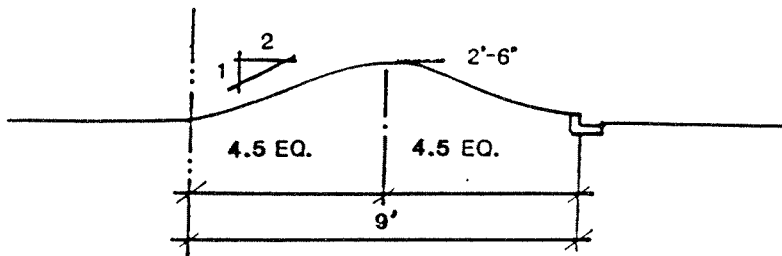

9' LANDSCAPE EASEMENT

**PACIFIC GATE-EAST GATE SPECIFIC PLAN**

**FIGURE V-A-17  
CONCEPTUAL STREET PLANT PALETTE**

<u>STREET</u>	<u>TREE</u>	<u>SHRUB</u>	<u>GROUNDCOVER</u>
WALL ST. BRICKELL ST.	EUCALYPTUS CLADOCALYX Sugar Gum	OSMANTHUS ILICIFOLIUS Holly-Leaf Osmanthus	TURF/ MYOPORUM PARVIFOLIUM
	PISTACIA CHINENSIS Chinese Pistache	XYLOSMA CONGESTUM Shiny Xylosma	
	TRISTANIA CONFERTA Brisbane box 15'-20'		
McNAMARA ST. KETERING DR. AUTO CENTER DR.	PYRUS CALLERYANA BRADFORD Bradford Pear	RAPHIOLEPSIS INDICA BALLERINA India Hawthorne	GAZANIA Trailing Gazania
WANAMAHER AVE. ROCHESTER AVE.	TRISTANIA CONFERTA Brisbane Box	TEUCRIUM GERMANDER Bush Germander	GAZANIA Trailing Gazania
SARAH PLACE North and South	PISTACHIA CHINENSIS Chinese Pistache	ELEAGNUS PUNGENS Silverberry HEMEROCALLIS HYBRID Daylily RAPHIOLIPIS INDICA Indian Hawthorne CALLISTEMON CITRINUS Lemon Bottle Brush	TURF/ MYOPORUM PARVIFOLIUM
JURUPA ST.	TRISTANIA CONFERTA Brisban Box BRACHICHYTON POPULNEUS Bottle Tree	HEMEROCALLIS HYBRID Daylily RAPHIOLEPIS INDICA Indian Hawthorne CALLISTEMON CITRINUS Lemon Bottle Brush	TURF/ MYOPORUM PARVIFOLIUM
SANTA ANA ST.	PISTACHIA CHINENSIS Chinese Pistache BRACHICHYTON POPULNEUS Bottle Tree PINUS ELDERICA Mondale Pine	HEMEROCALLIS HYBRID Daylily RAPHIOLEPIS INDICA Indian Hawthorne CALLISTEMON CITRINUS Lemon Bottle Brush	TURF/ MYOPORUM PARVIFOLIUM

**PACIFIC GATE-EAST GATE SPECIFIC PLAN**

CONCEPTUAL STREET PLANT PALETTE (cont'd)

<u>STREET</u>	<u>TREE</u>	<u>SHRUB</u>	<u>GROUNDCOVER</u>
AIRPORT DR.	ZELKOVA SERRATA Japanese Zelkova	MYRSINEZ AFRICANA African Boxwood CARISSA GRANDIFLORA Natal Plum	GAZANIA Trailing Gazania ALYSSUM Alyssum
PRIMARY ENTRANCE	PINUS CANARIENSIS Canary Island Pine PRUNUS CERASIFERA Purple Leaf Plum	ESCALLONIA HEMEROCALLIS HYBRID Daylily	TALL FESCUE TURF/ANNUAL COLOR
SECONDARY ENTRANCE	TRISTANIA CONFERTA Brisbane Box LAGERSTROEMIA INDICA	ESCALLONIA HEMEROCALLIS HYBRID	TALL FESCUE TURF/ANNUAL COLOR

## PACIFIC GATE-EAST GATE SPECIFIC PLAN

### 3. Street Intersections Landscape/ Identity Statements

See Figures V-A-17 through V-A-19.

### B. ON-SITE LANDSCAPING

Landscape criteria have also been established for landscaping of on-site areas. This landscaping will be the responsibility of individual parcel owners, and will be reviewed and approved by the City of Ontario as part of the site plan approval process.

On-site landscaped areas will include building and parking setbacks, parking areas, buffers, and areas directly adjacent to buildings including building entries. The landscape for these areas will provide a mixture of trees, shrubs, vines, groundcover and turf, as appropriate (see Figures V-B-1 and V-B-3, On-Site Landscaping.) A recommended plant palette has been provided that offers a variety of plant material that do well in this climate (see Figure V-B-3, Recommended Plant Palette for On-Site Landscape Development Plans).

Since the water requirements of plant materials may vary extensively, attention should be given to selecting plants with similar water requirements in particular planting areas. Attention should also be given to installing irrigation systems that can regulate water requirements as needed.

Minimum sizes for tree materials shall be 15 gallons and shall include 25% of interior trees to be sized 24" box or larger; minimum sizes for shrub plant material shall be 5 gallons. Smaller container-size plant material must be approved by the City of Ontario's Public Facilities Development Department.

The quantity and actual placement of trees, shrubs, groundcover and turf shall be adequate to screen and soften buildings and their associated loading and parking areas from adjacent public streets and to visually enhance building entries. Such landscaping shall be designed with consideration given to parcel size and the intended building use.

# ENTRANCE IDENTITY CONCEPTUAL PLAN

FIGURE  
V-A-18

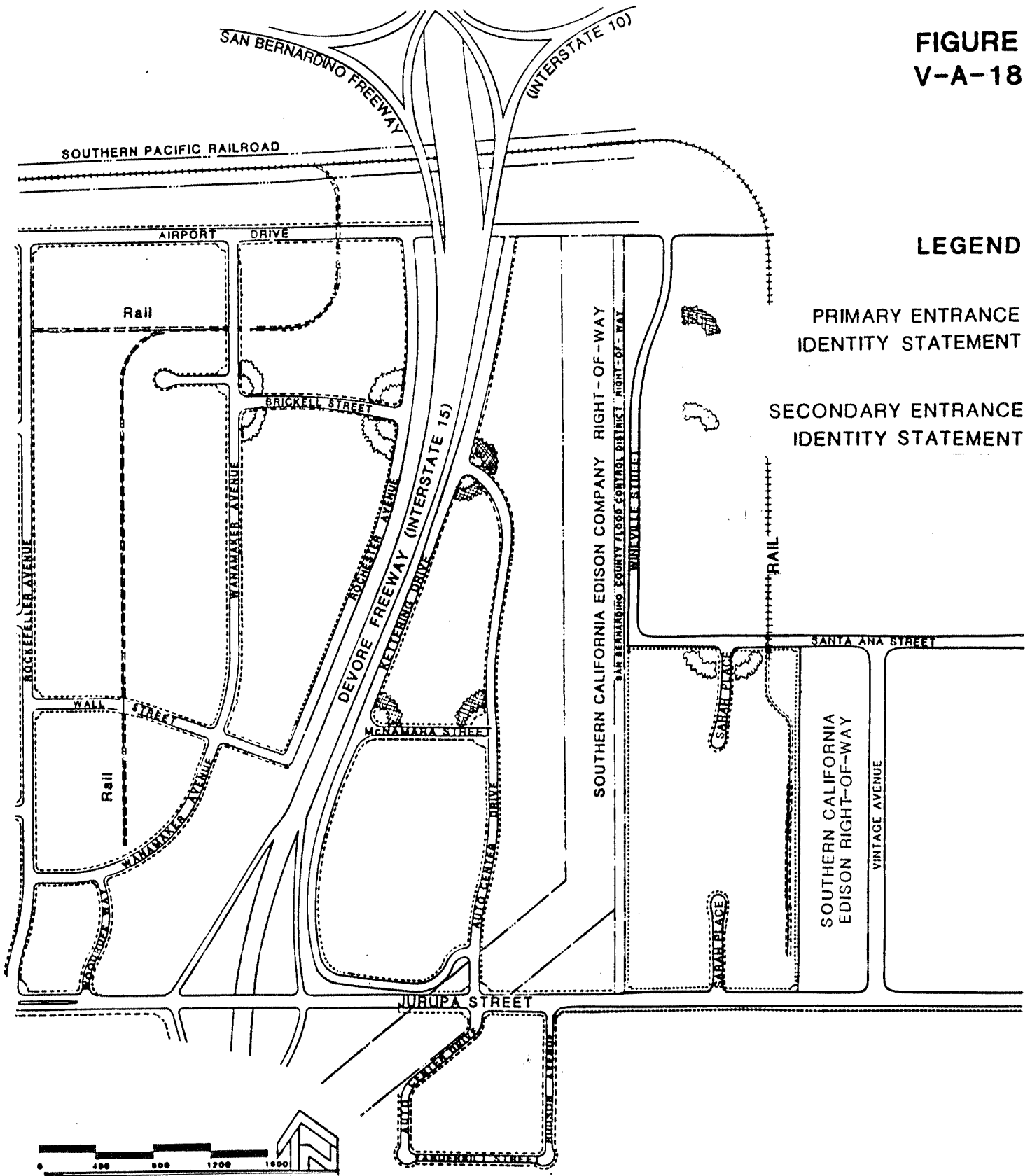

**PACIFIC GATE - EAST GATE SPECIFIC PLAN**  
**SANTA FE PACIFIC REALTY CORPORATION**

# CONCEPTUAL PRIMARY ENTRANCE IDENTITY STATEMENT

FIGURE  
V-A-19

TALL COLUMNAR EVERGREEN TREES  
PINUS CANARIENSIS  
(CANARY ISLAND PINE)

FLOWERING CANOPY TREES  
PRUNUS CERASIFERA  
'Auroopurpurea'  
(PURPLE LEAF PLUM)

GROUND COVER

TALL FESCUE TURF  
SHRUBS/ANNUAL  
COLOR

LOW TERRACE WALL  
(OPTIONAL)

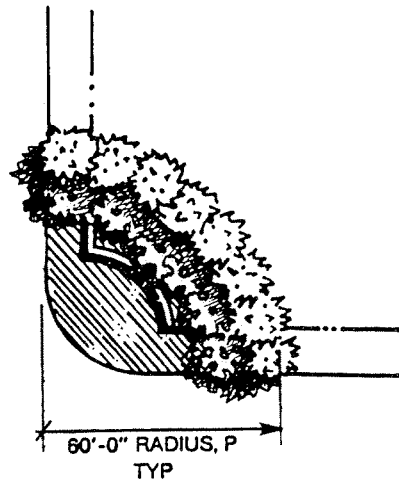
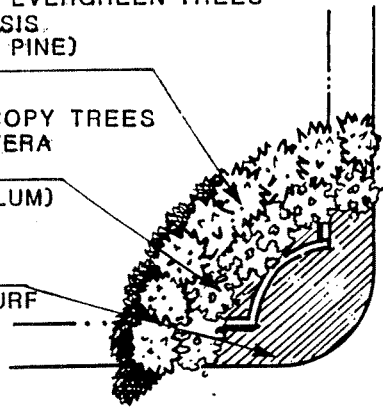

CONCEPTUAL PLAN  
(Not to Scale)

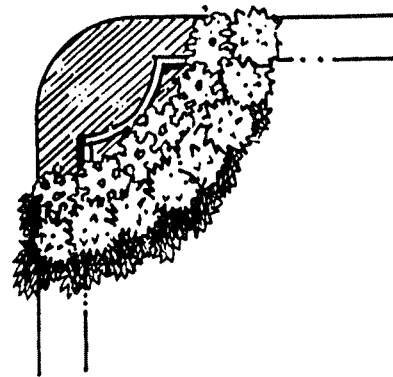
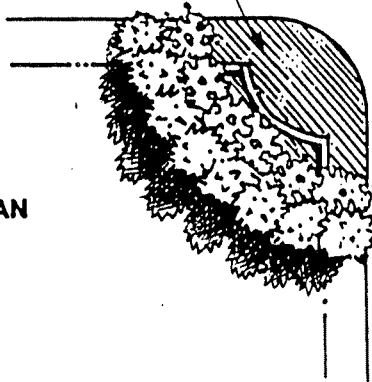

COLUMNAR EVERGREEN  
TREES

FLOWERING CANOPY  
TREES

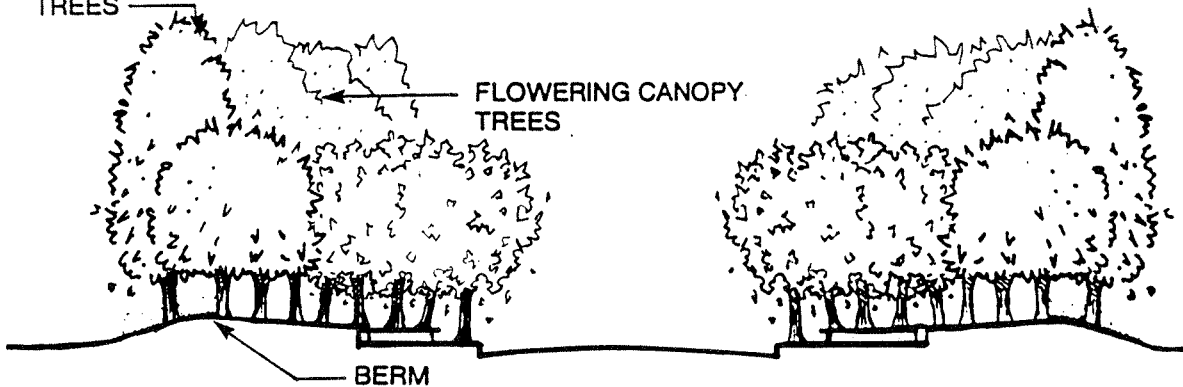

CONCEPTUAL SECTION  
(Not to Scale)



PACIFIC GATE - EAST GATE SPECIFIC PLAN  
SANTA FE PACIFIC REALTY CORPORATION

# CONCEPTUAL SECONDARY ENTRANCE IDENTITY STATEMENT

EVERGREEN, CANOPY TREES  
TRISTANIA CONFERTA (BRISBANE BOX)

FLOWERING, ACCENT TREES  
LAGERSTROEMIA INDICA

BOLLARD (OPTIONAL)

GROUND COVER  
TALL FESCUE TURF  
SHRUBS/ANNUAL COLOR

FIGURE  
V-A-20

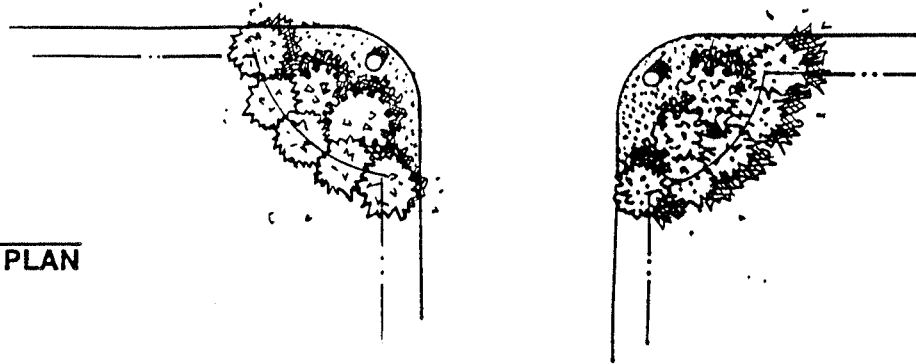
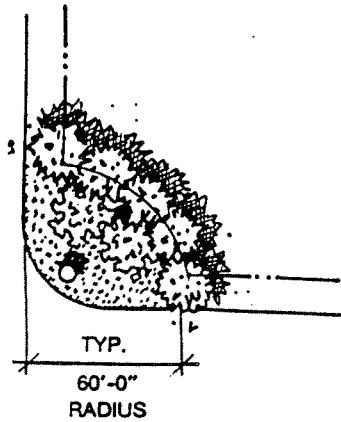

**CONCEPTUAL PLAN**  
(Not to Scale)

EVERGREEN, CANOPY  
TREES  
FLOWERING,  
ACCENT  
TREES

BOLLARDS  
(OPTIONAL)

BERM

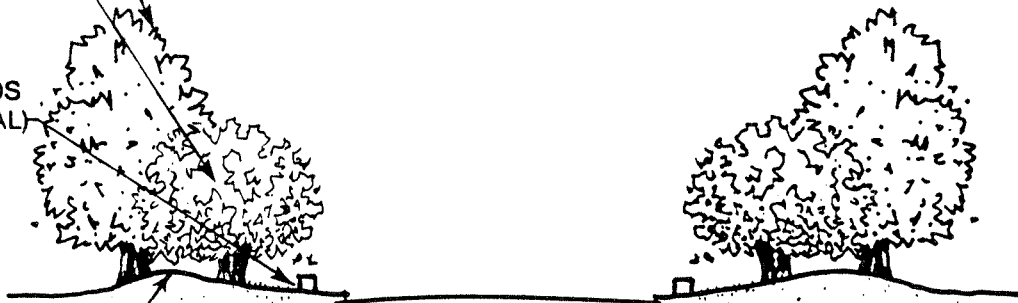

**CONCEPTUAL SECTION**  
(Not to Scale)



# ON-SITE LANDSCAPING

FIGURE  
V-B-1

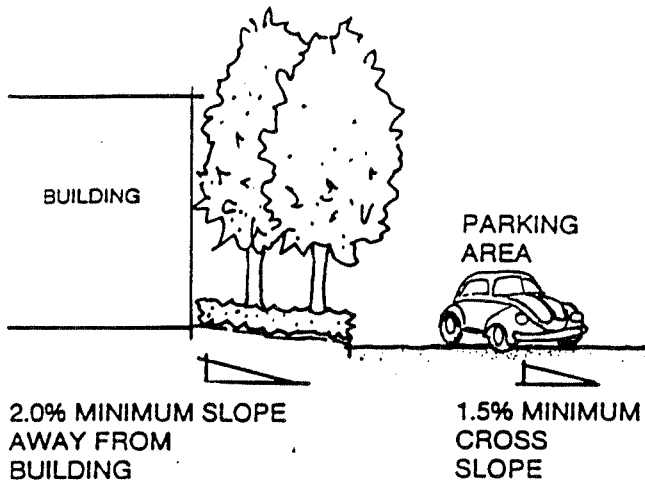

SMOOTH TRANSITIONS WITH SOFT, NATURAL FORMS ARE RECOMMENDED FOR BERMS



BERMS ARE NOT TO BE ABRUPT or "LUMPY"

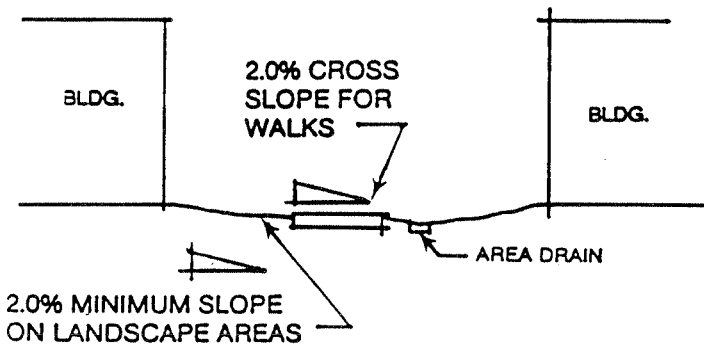

IN AREAS OF LIMITED HORIZONTAL RUN, A CONTINUOUS BERM IS RECOMMENDED

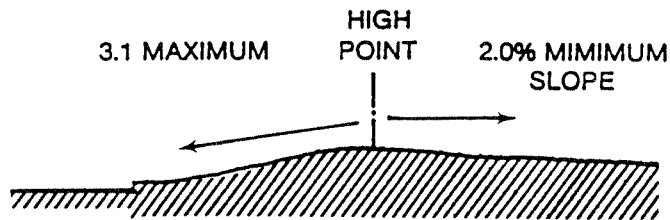
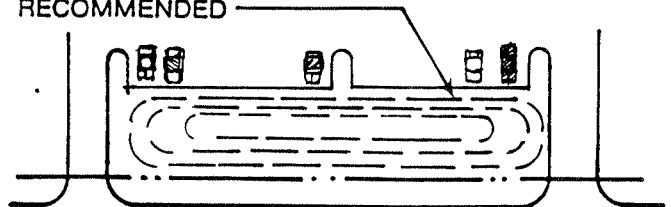

LAWN SLOPES  
GRADING CONCEPTS  
(Not to Scale)

BERMING CONCEPT  
(Not to Scale)



# ON-SITE LANDSCAPING

(Continued)

FIGURE

V-B-2



## DESIGN CONCEPT • ON-SITE LANDSCAPING

THE OVERALL INTENTION IS THE CREATION OF A SIMPLE, STRONG LANDSCAPE SETTING, IN SCALE WITH LARGE BUILDINGS, WIDE STREETS, and LARGE PARKING AREAS OF AN INDUSTRIAL/BUSINESS CENTER. THIS RESULT CAN BE ACHIEVED THROUGH THE USE OF A LIMITED PALETTE, WITH SKILLFULLY ARRANGED MASSING OF SIMILAR PLANT MATERIALS, ESPECIALLY ALONG STREET FRONTAGES and AT VEHICULAR ENTRIES. LARGE SWEEPS OF SINGLE SPECIES ARE RECOMMENDED. MORE DETAIL, ACCENT TREES and SHRUBS ARE RECOMMENDED FOR COURTYARDS, GARDENS and FORMAL ENTRIES.

# RECOMMENDED PLANT PALETTE FOR ON-SITE LANDSCAPE DEVELOPMENT PLANS

FIGURE  
V-B-3

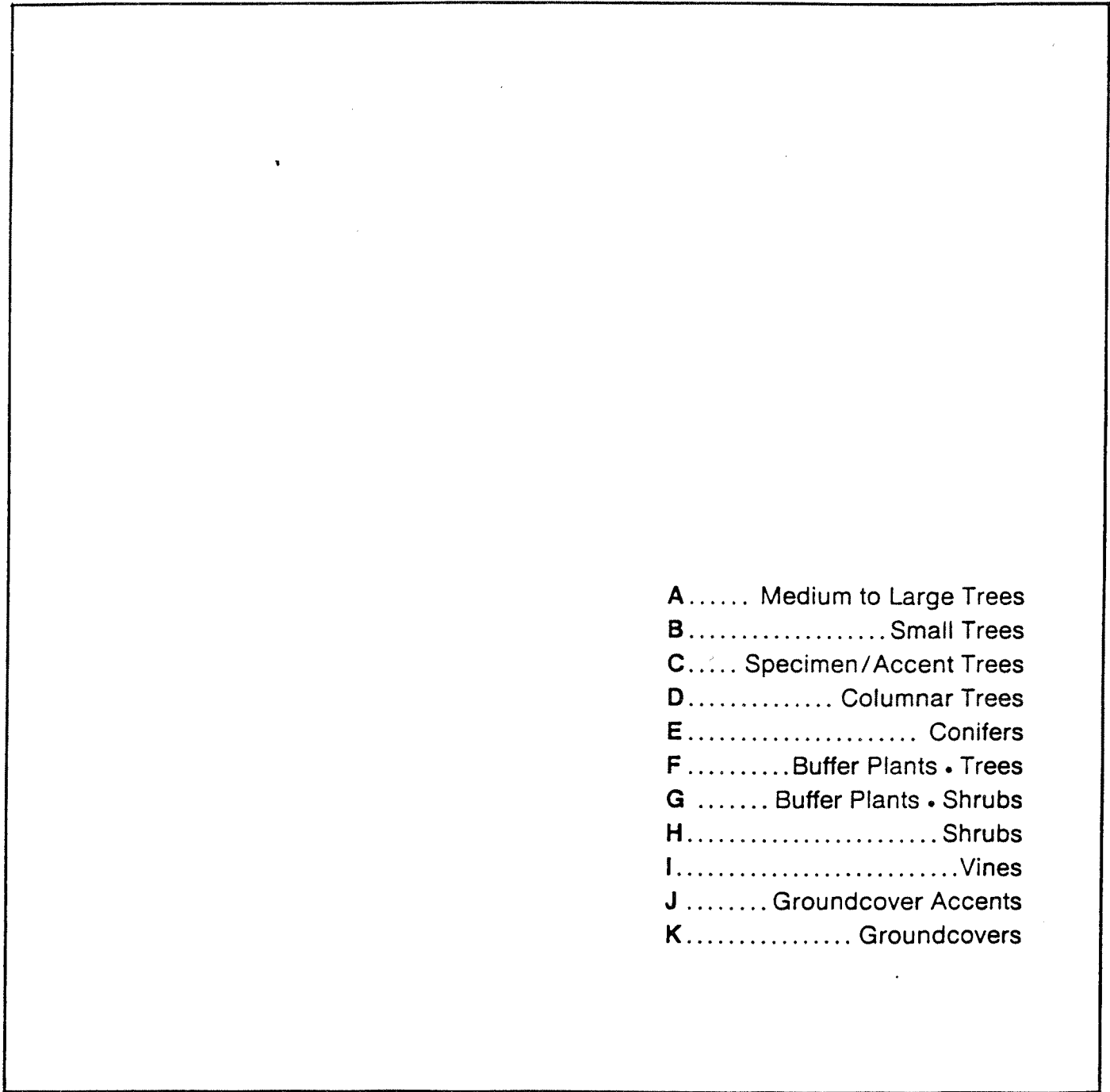

- A..... Medium to Large Trees
- B..... Small Trees
- C..... Specimen/Accent Trees
- D..... Columnar Trees
- E..... Conifers
- F..... Buffer Plants • Trees
- G..... Buffer Plants • Shrubs
- H..... Shrubs
- I..... Vines
- J..... Groundcover Accents
- K..... Groundcovers

A. MEDIUM to LARGE TREES

PLANT NAME	EVERGREEN	DECIDUOUS	HEIGHT	SOUTHWEST EXPOSURE	DROUGHT TOLERANT	GROWTH RATE	SEASONAL COLOR	COMMENTS
BRACHYCHITON POPULNEUS Bottle Tree	•		40'	•	•	M		Wind tolerant
CHORISIA SPECIOSA 'Majestic Beauty' Floss-Silk Tree		•	50'	•		M	Fall Pink	
EUCALYPTUS CAMADULENSIS Red Gum	•		100'	•	•	F		Some litter
EUCALYPTUS CLADOCALYX Sugar Gum	•		85'	•	•	F		Some litter
EUCALYPTUS LEUCOXYLON White Ironbark	•		50'	•		F		Wind tolerant Some Litter
EUCALYPTUS MACULATA Spotted Gum	•		60'			F		Some litter
EUCALYPTUS MICROTHECA Flodded Box	•		35'	•		F		Wind tolerant Some litter
EUCALYPTUS SIDEROXYLON 'Rosea' Red Ironbark	•		50'			M	Fall to Spring Pink	Some litter
EUCALYPTUS VIMINALIS Manna Gum	•		100'			F		Some litter
GINKGO BILOBA 'Autumn Gold' - Male Only Maidenhair Tree		•	50'	•	M	F	Fall Gold	
GINKGO BILOBA 'Saratoga' - Male Only Maidenhair Tree		•	50'	•	M	S	Fall Pink	
GLEDITSIA TRIACANTHOS Honey Locust		•	50'	•	L	F		Wind tolerant Surface roots. Some litter
GREVILLEA ROBUSTA Miliken Parkway Only Silk Oak	•		50'	•		F		
LIQUIDAMBAR FORMOSANA Chinese Sweet Gum		•	50'		L	M	Spring & Fall Red	Surface roots
LIQUIDAMBAR STYRACIFLUA American Sweet Gum		•	60'			M	Fall Red	Surface roots
LIQUIDAMBAR STYRACIFLUA 'Burgundy' Burgundy Sweet Gum		•	60'		L	M	Fall Winter Purple	Surface roots
LIRIODENDRON TULIPIFERA Tulip Tree		•	50'		L	F	Fall Yellow	Surface roots
MAYTENUS BOARIA Mayten Tree	•		40'		M	M		
MELALEUCA LINARIFOLIA Flaxleaf Paperback	•		35'	•	•	F		
MELALEUCA STYPHELIODES	•		40'	•	•	F		
PISTACIA CHINENSIS Chinese Pistache		•	60'	•	M	M	Fall Crimson	Some litter
PLATANUS ACERIFOLIA London Plane Tree		•	80'		L	F		
PLATANUS RACEMOSA California Sycamore		•	80'	•	M	F		Wind tolerant Some litter
POPULUS FREMONTII - Male Only Western Cottonwood		•	50'	•	M	F		
SCHINUS MOLLE California Pepper	•		35'		•	F		Surface roots
TRISTANIA CONFERTA Brisbane Box	•		50'	•	•	F	Summer White	Some litter
ULMUS PARVIFOLIA - Drake or Brea Chinese Elm		•	50'		M	F		
ZELKOVA SERRATA Japanese Zelkova		•	60'	•	L	F	Fall Yellow	

## B. SMALL TREES

PLANT NAME	EVERGREEN	DECIDUOUS	HEIGHT	SOUTHWEST EXPOSURE	DROUGHT TOLERANT	GROWTH RATE	SEASONAL COLOR	COMMENTS
ACACIA BAILEYANA Bailey Acacia	•	25'	•	•	F	Spring Yellow	Wind tolerant Surface roots	
ACACIA BAILEYANA 'Purpurea' Purple-leaf Acacia	•	25'	•	•	F	Spring Yellow	Wind tolerant Surface roots	
ACACIA MELANOXYLON Black Acacia	•	40'	•	•	F	Spring Yellow	Wind smog tolerant Surface roots	
ALBIZIA JULIBRISSIN 'Rosea' Silk Tree	•	40'	•	•	F	Summer Pink		
CERATONIA SILIQUA Carob	•	35'	•	•	M		Surface roots	
GEIJERA PARVIFLORA Australian Willow	•	25'	•	M	F			
JACARANDA MIMOSIFOLIA Jacaranda	•	30'	•	L	M	Spring, Summer Lavender-blue		
KOELREUTERIA PANICULATA Golden Rain Tree	•	25'	•	•	M	Summer, Fall Yellow	Wind, smog tolerant	
LIQUIDAMBAR ORIENTALIS Oriental Sweet Gum	•	25'		M	M	Fall Red		
RHUS LANCEA African Sumac	•	25'	•	•	M			

## C. SPECIMEN/ACCENT TREES

BRACHYCHITON ACERIFOLIUS Flame Tree	•	50'	•	M	S	Summer Red	
CHORISIA SPECIOSA 'Majestic Beauty' Floss-Silk Tree	•	50'	•		M	Fall Pink	
CINNAMOMUM CAMPHORA Camphor Tree	•	40'			S	Spring Flowers	Surface roots
FAGUS SYLVATICA 'Atropunicea' Purple Beech	•	60'	•	No	M		
LAGERSTROEMIA INDICA Crape Myrtle	•	20'	•	•	S	Spring, Summer White, Pink	
MAGNOLIA GRANDIFLORA 'Samuel Sommer' Samuel Sommer Magnolia	•	50'	•		M	Summer, Fall White	Surface roots Some litter
MELIA AZEDARACH 'Umbraculifera' Texas Umbrella Tree	•	30'	•		M		
PRUNUS CERASIFERA 'Atropurpurea' Purple-leaf Plum	•	30'	•	No	M	Spring White	

## D. COLUMNAR TREES

LIQUIDAMBAR STYRACIFLUA 'Festival' Sweetgum	•	50'	•	L	M	Fall Orange	Surface roots
POPULUS NIGRA 'Italica' Lombardy Poplar	•	60'		L	F		

**PLANNING NETWORK**  
 Land Planning and Design • Policy Analysis  
 Environmental Studies • Project Management  
 7940 East 6 Street, Suite 105  
 Ontario, CA 91764  
 Tel (714) 945-7738

**PACIFIC GATE - EAST GATE SPECIFIC PLAN**  
**SANTA FE PACIFIC REALTY CORPORATION**

## E. CONIFERS

PLANT NAME	EVERGREEN	DECIDUOUS	HEIGHT	SOUTHWEST EXPOSURE	DROUGHT TOLERANT	GROWTH RATE	SEASONAL COLOR	COMMENTS
PINUS CANARIENSIS Canary Island Pine	•		70'	•	M	F		Wind tolerant
PINUS COULTERI Coulter Pine	•		50'	•		M		Wind tolerant
PINUS HALEPENSIS Aleppo Pine	•		40'	•		F		Wind tolerant
PINUS PINEA Italian Stone Pine	•		50'	•		M		Wind tolerant

## F. BUFFER PLANTS • TREES

CERATONIA SILIQUA Carob	•		25'	•		M		
EUCALYPTUS SIDEROXYLON 'Rosea' Red Ironbark	•		50'	•		M	Fall to Spring Pink	Some litter
PINUS HALEPENSIS Aleppo Pine	•		40'	•		F		Wind tolerant
PINUS PINEA Italian Stone Pine	•		50'	•		M		Wind tolerant
TRISTANIA CONFERTA Brisbane Box	•		50'	•		F	Summer White	Some litter

## G. BUFFER PLANTS • SHRUBS

ACACIA MELANOXYLON Black Acacia	•		40'	•		F	Spring Yellow	Wind, smog tolerant Surface roots
DODONAEA VISCOSA 'Purpurea' Hopseed Tree	•		15'	•		F		Wind smog tolerant
FEIJOA SELLOWIANA Pineapple Guava	•		12'	•		M		
LEPTOSPERMUM LAEVIGATUM Australian Tea Tree	•		15'	•		F	Spring White	Wind tolerant
LIGUSTRUM JAPONICUM 'Texanum' Japanese Privet	•		9'	•	No	M	Spring, Summer White	
LIGUSTRUM OVAFOLIUM California	•		15'	•	No	F	Spring, Summer White	
MELALEUCA NESOPHILA Pink Melaleuca	•		20'	•		F	Summer Pink-Purple	Wind tolerant
MYRTUS COMMUNIS True Myrtle	•		15'	•		S	Summer White	
NERIUM OLEANDER Oleander	•		12'	•		F	Spring Fall White, Pink	Wind smog tolerant
OSMANTHUS ILICIFOLIUS Holly-Leaf Osmanthus	•		8'		L	M	Fall White	
VIBURNUM JAPONICUM Japanese Viburnum	•		15'		L	M	Spring White	

H. SHRUBS

PLANT NAME	EVERGREEN		DECIDUOUS		HEIGHT	SOUTHWEST EXPOSURE	DROUGHT TOLERANT	GROWTH RATE	SEASONAL COLOR	COMMENTS
	•	•	•	•						
ABELIA GRANDIFLORA Glossy Abelia	•		8'	•	L	F	Summer Pink		Good hedge	
ARBUTUS UNEDO 'Compacta' Compact Strawberry Tree	•		5'	•	M	M	Fall, Winter Pink			
CALLISTEMON CITRINUS Lemon Bottlebrush	•		15'	•	M	F	Spring to Winter Red		Wind, smog tolerant Good hedge	
CARISSA GRANDIFLORA Natal Plum	•		7'	•	M	F	Spring to Winter Red		Wind, smog tolerant Good hedge	
CEANOTHUS 'Julia Phelps' Julia Phelps Ceanothus	•		5'	•		F	Spring Blue		Wild tolerant	
CEANOTHUS RIGIDUS 'Snowball' Snowball Ceanothus	•		6'	•		F	Spring White		Wind tolerant	
CISTUS LADANIFER Spotted Rock Rose	•		6'	•		F	Spring, Summer White		Wind tolerant	
CISTUS PURPUREUS Orchid-Spot Rock Rose	•		4'	•		F	Spring, Summer Orchid		Wind tolerant	
COTINUS COGGYGRIA 'Purpureus' Purple Smoke Tree	•		20'	•		M	Fall Yellow-Orange		Good hedge Not too much H <sub>2</sub> O	
DODONAEA VISCOSA 'Purpurea' Purple Hop Bush	•		15'	•		F			Wind, smog tolerant Good hedge	
ERYTHRINA BIDWILLII Bidwill's Coral Tree		•	15'	•	L	F			Wind tolerant	
FEIJOWA SELLOWIANA Pineapple Guave	•		12'	•		M	Spring, Pink			
FREMONTODENDRON CALIFORNICUM Flannel Bush	•		15'	•		F	Spring Yellow		Not too much H <sub>2</sub> O	
GARRYA ELLIPTICA Coast Silktassel	•		10'	•	M	M	Spring to Winter Red		Needs both Male and Female	
HETEROMELES ARBUTIFOLIA California Holly	•		20'	•		M	Summer-Winter Cream and Red		Smog tolerant	
LEPTOSPERMUM LAEVIGATUM Australian Tea Tree	•		15'	•		F	Spring White		Wind tolerant Good hedge	
LIGUSTRUM JAPONICUM 'Texanum' Japanese Privet	•		9'	•	No	M	Spring, Summer White		Good hedge	
LIGUSTRUM OVAFOLIUM California Privet	•		15'	•	No	F	Spring, Summer White		Good hedge	
MELALEUCA NESOPHILA Pink Melaleuca	•		20'	•		F	Summer Pink, Purple		Wind tolerant Good hedge	
MYRSINE AFRICANA African Boxwood	•		8'	•		M			Smog tolerant	
MYRTUS COMMUNIS True Myrtle	•		6'	•		S	Summer White		Good hedge	
NERIUM OLEANDER Oleander	•		12'	•		F	Spring to Fall White, Pink		Wind, smog tolerant Good hedge	
OSMANTHUS ILICIFOLIUS Holly-Leaf Osmanthus	•		8'	•		S	Fall White		Good hedge	
PITTOSPORUM TOBIRA Mock Orange	•		15'	•	M	M	Spring White			
PITTOSPORUM TOBIRA 'Wheeler' Mock Orange	•		2'	•	M	M	Spring White			

Continued

H. SHRUBS (Continued)

PLANT NAME								COMMENTS
	EVERGREEN	DECIDUOUS	HEIGHT	SOUTHWEST EXPOSURE	DROUGHT TOLERANT	GROWTH RATE	SEASONAL COLOR	
PLUMBAGO AURICULATA Blue Cape Plumbago	•		6'	•	•	M	Spring to winter Blue	
RAPHIOLEPIS INDICA India Hawthorn	•		5'	•		M S	Fall to Spring Pink	Smog tolerant
RHUS OVATA Sugar Bush	•		6'	•		M M	Spring Pink	
TEUCRIUM FRUTICANS Bush Germander	•		6'	•	•	M	Summer Blue	Not too much H <sub>2</sub> O
VIBURNUM JAPONICUM Japanese Viburnum	•		15'			L M	Spring White	Needs some shade
XYLOSMA CONGESTUM Shiny Xylosma	•		9'	•		M F		
JUNIPERUS CHINENSIS 'Pfitzerana' Pfitzer Juniper	•		15'	•	•	M		

I. VINES

AKEBIA QUINATA Fiveleaf Akebia	•			•	No	F	Summer Purple	Shade tolerant Needs support
CLEMATIS ARMANDII Evergreen Clematis	•			•	No	F	Spring White	Shade tolerant Needs support
CLYTOSTOMA CALLISTEGODES Violet Trumpet Vine	•			•	No	F	Spring to Fall Violet	Shade tolerant Needs support
FICUS PUMILA Creeping Fig	•			•		M F		Shade tolerant
JASMINUM GRANDIFLORUM Spanish Jasmine	•					L F	Summer White	Shade tolerant Needs support
PASSIFLORA ALATOCAERULEA Passion Vine	•			•	No	F	Summer White	
PASSIFLORA JAMESONII Red Passion Flower	•			•	No	F	Summer Coral	
ROSA BANKSIAE 'Lutea' Lady Bank's Rose	•			•		M M	Spring, Summer Yellow	Needs support
SOLANUM JASMINOIDES Potato Vine	•			•	No	F	Spring to Winter White	Shade tolerant Needs support
WISTERIA FLORIBUNDA Japanese Wisteria	•			•	No	F	Spring Purple	Shade tolerant Needs support
WISTERIA SINENSIS Chinese Wistena	•			•	No	F	Spring Purple	Shade tolerant Needs support

J. GROUNDCOVER ACCENTS

AGAPANTHUS AFRICANUS Lily-of-the-Nile	•		11'	•	•	F	Summer Blue	Shade tolerant
ARTEMISIA SCHMIDTIANA 'Silver Mound' Angel's Hair			12'	•	•	M		
HEMEROCALLIS Day Lily			8'	•	No	M	Summer, Fall Yellow, Orange	Needs shade
LIRIOPE MUSCARI Lily Turf	•		8'		No	M	Summer Lavender	
MORAEA IRIDIODES African Iris	•			•	•	M	Spring to Fall White	

## K. GROUNDCOVERS

PLANT NAME	EVERGREEN	DECIDUOUS	HEIGHT	SOUTHWEST EXPOSURE	DROUGHT TOLERANT	GROWTH RATE	SEASONAL COLOR	COMMENTS
ACACIA REDOLENS Acacia	•		3'	•	•	F	Spring Yellow	Wind, smog tolerant
ARCTOTHECA CALENDULA Cape Weed	•		10'	•	•	F	Spring to Winter Yellow	
ARMERIA MARITIMA Sea Pink	•		6'	•	•	M	Spring Pink	
BACCHARIS PILULARIS 'Twin Peaks' Coyote Brush	•		12'	•	•	M		Wind, smog tolerant
CEANOTHUS GRISEUS HORIZONTALIS 'Santa Ana'	•		2'	•	•	F	Spring Blue	Wind tolerant
COTONEASTER DAMMERI 'Lowfast' Bearberry Cotoneaster	•		6'	•	•	F	Spring White	
GAZANIA RIGENS LEUCOLAENA Gazania	•		10'	•	M	F	Spring to Winter Yellow to Red	
HYPERICUM CALYGINUM St. Johnswort	•		1'	•	M	M	Spring Yellow	
JUNIPERUS CHINENSIS 'Procumbens Nana' Japanese Garden Juniper	•		1'	•	•	M		
JUNIPERUS HORIZONTALIS 'Blue Rug' Blue Rug Juniper	•		4'	•	•	M		
JUNIPERUS SABINA 'Buffalo' Sabina Juniper	•		12'			M		
LANTANA MONTEVIDENSIS Lantana	•		2'	•	M	F	Spring to Winter Lilac	Smog tolerant
LONICERA JAPONICA 'Halliana' Japanese Honeysuckle	•		18'	•	M	F	Spring, Summer White to Yellow	
MYOPORUM PARVIFOLIUM Myoporum	•		3'	•	M	F	Summer White	
O'CONNOR'S LEGUME	•		6'	•	M	F		Wind, smog tolerant
ROSEMARINUS OFFICINALIS Rosemary	•		4'	•	•	F	Winter, Spring Orchid	
THYMUS HERBA-BARONA Caraway-Scented Thyme	•		6'	•	M	F	Summer, Fall Rose-Pink	
BERMUDA Santa Ana Tiffgreen								Warm season
TALL FESCUE Rebel, Hounddog, Olympic								Cool season
ACHILLEA MILLEFOLIUM Yarrow								