

# SIGN PROGRAM COVER SHEET

SIGN PROGRAM NO. 91-70

## TO BE COMPLETED BY THE PLANNER:

SIGN ADDRESS (include N, S, E, W) 4551 E. PHILADELPHIA

RELATED ITEMS FILE NO 4247-S (BAXTER)

RECEIVED BY KH

DATE 6/12/91

## TO BE COMPLETED BY APPLICANT

OWNER BAXTER HEALTHCARE CORP TELEPHONE \_\_\_\_\_

MAILING ADDRESS \_\_\_\_\_

CITY, STATE, ZIP CODE \_\_\_\_\_

REPRESENTATIVE \_\_\_\_\_

TELEPHONE \_\_\_\_\_

MAILING ADDRESS \_\_\_\_\_

CITY, STATE, ZIP CODE \_\_\_\_\_

## BACKGROUND INFORMATION

ZONE: M2 EUCLID OVERLAY DISTRICT? YES  NO

FRONTAGE: SITE: \_\_\_\_\_ BUILDING/TENANT SPACE: \_\_\_\_\_

SIDE FRONTAGE (CORNER LOT): SITE: \_\_\_\_\_ BLDG./SPACE: \_\_\_\_\_

REAR (PUBLIC ENTRANCE FROM ALLEY/PARKING LOT): \_\_\_\_\_

SITE/SURROUNDING PROPERTY CONDITIONS: \_\_\_\_\_

## PROPOSED/EXISTING SIGNS

	WALL (sq.ft.)	FREESTANDING (sq.ft.) (height)	OTHER (Master ID, Freeway, etc.)
EXISTING SIGNS			
PROPOSED SIGNS			
CODE LIMITS			

PROPOSED SIGN LOCATION NOTES: \_\_\_\_\_

## ACTION

COUNTER  
DATE: 6/19/91  
ACTION: APPROVED  
PLANNER: KH

PLANNING COMMISSION  
MEETING DATE: \_\_\_\_\_  
ACTION: \_\_\_\_\_

# SIGN PLAN COVER SHEET

SIGN PLAN NO. \_\_\_\_\_

## TO BE COMPLETED BY THE PLANNER:

SIGN ADDRESS (include N, S, E, W) 4551 E. PHILADELPHIA ST

RELATED ITEMS 4247-S

RECEIVED BY KH

DATE 4/5/91

## TO BE COMPLETED BY APPLICANT

OWNER BAXTER HEALTHCARE CORP. TELEPHONE (312)948-4064

MAILING ADDRESS ONE BAXTER PARKWAY

CITY, STATE, ZIP CODE DEERFIELD, ILLINOIS 60015

REPRESENTATIVE PERIDIAN (JOHN VANDERHOE) TELEPHONE 714 261 5120

MAILING ADDRESS 17848 SLY PARK CIRCLE

CITY, STATE, ZIP CODE IRVINE, CA. 92714

BACKGROUND INFORMATION	ZONE: <u>M2</u> EUCLID OVERLAY DISTRICT? YES <input type="checkbox"/> NO <input checked="" type="checkbox"/>
	FRONTAGE: SITE: _____ BUILDING/TENANT SPACE: _____
	SIDE FRONTAGE (CORNER LOT): SITE: _____ BLDG./SPACE: _____
	REAR (PUBLIC ENTRANCE FROM ALLEY/PARKING LOT): _____
	SITE/SURROUNDING PROPERTY CONDITIONS: _____

PROPOSED/EXISTING SIGNS		WALL (sq.ft.)	FREESTANDING (sq.ft.) (height)	OTHER (Master ID, Freeway, etc.)
	EXISTING SIGNS			
	PROPOSED SIGNS			<u>PER SIGN PROGRAM</u>
	CODE LIMITS			
	PROPOSED SIGN LOCATION NOTES: _____			

ACTION	COUNTER	PLANNING COMMISSION
	DATE: <u>6/19/91</u>	MEETING DATE: _____
	ACTION: <u>APPROVED</u>	ACTION: _____
	PLANNER: <u>KH</u>	

Pa # 715 Rect # 128726 4/5/91



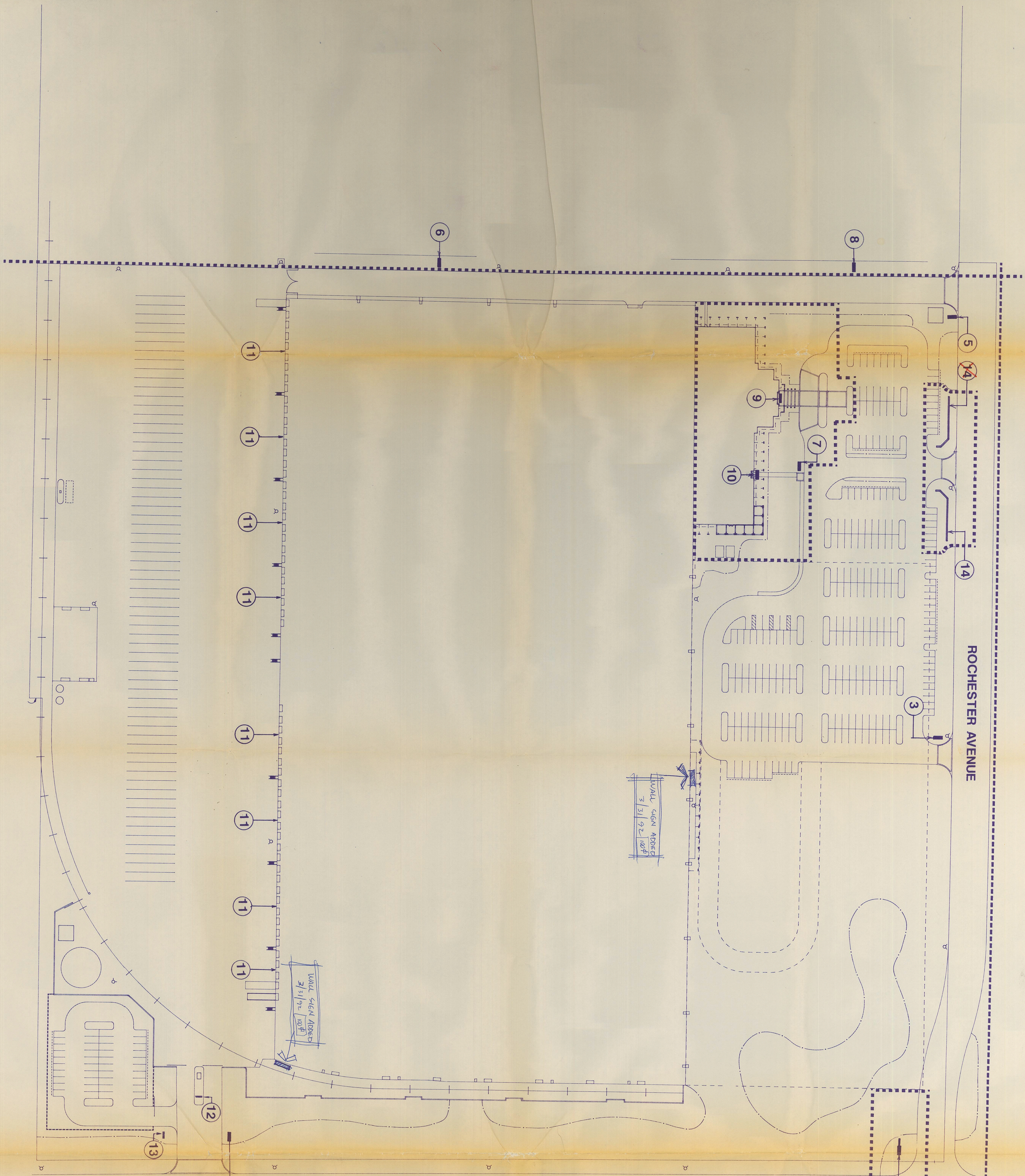

ROCHESTER AVENUE

PHILADELPHIA STREET

SIGN I.D.	DESCRIPTION	SHEET
1	DIRECTIONAL SIGN	S-1
2	DIRECTIONAL SIGN	S-1
3	DIRECTIONAL SIGN	S-1
4	DIRECTIONAL SIGN	S-2
5	DIRECTIONAL SIGN	S-2
6	DIRECTIONAL SIGN	S-2
7	DIRECTIONAL SIGN	S-3
8	DIRECTIONAL SIGN	S-3
9	MAIN ENTRY SIGN	S-3
10	EMPLOYEE ENTRY	S-4
11	DOCK DOOR I.D.	S-4
12	DIRECTIONAL SIGN	S-5
13	DIRECTIONAL SIGN	S-5
14	SITE ENTRY SIGN	C-3,D-1
15	SITE MONUMENT SIGN	C-3,D-1

**SIGNAGE LEGEND**

RECEIVED  
CITY OF ONTARIO  
TRANSPORTATION  
JUN 12 1991  
AM

Sign Program  
CH KH P. Baxter, Daph  
6/14/91

SCALE: 1" = 50'

<p>DATE: JUN 11 1991</p> <p>SHEET: SIGNAGE PROGRAM</p>	<p><b>Baxter</b> DISTRIBUTION CENTER ONTARIO, CALIFORNIA</p>	<p>Revision: 1 REVISED SITE I.D. Signs</p>	<p>Date: 6/21/91</p> <p>By: JAO</p>	<p>Appr: [Signature]</p> <p>Date: 4/4/91</p> <p>Lic. #: [Blank]</p> <p>State: [Blank]</p>	<p>The use of these plans &amp; specifications shall be restricted to the project for which they were prepared &amp; no other use without the express consent of Peridian is intended. Title to the plans &amp; specifications in Peridian without prejudice. Contact with these plans &amp; specifications constitute prima facie evidence of acceptance of these restrictions.</p> <p>Landscape Architecture &amp; Planning Peridian Inc. 1525 Sky Park Irvine, CA 92714 714.261.0121</p>
--	--	--	-------------------------------------	---	---

PERIDIAN



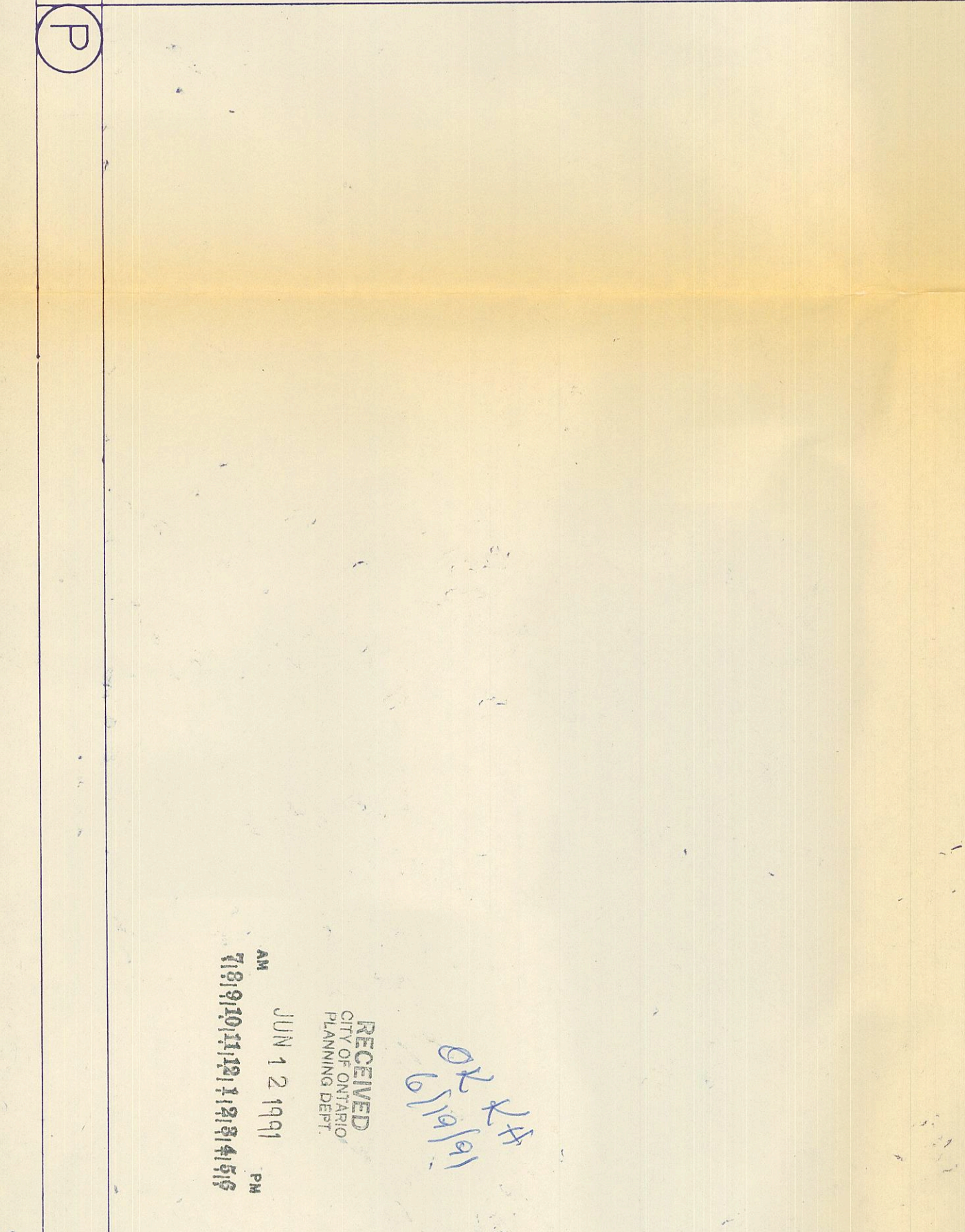
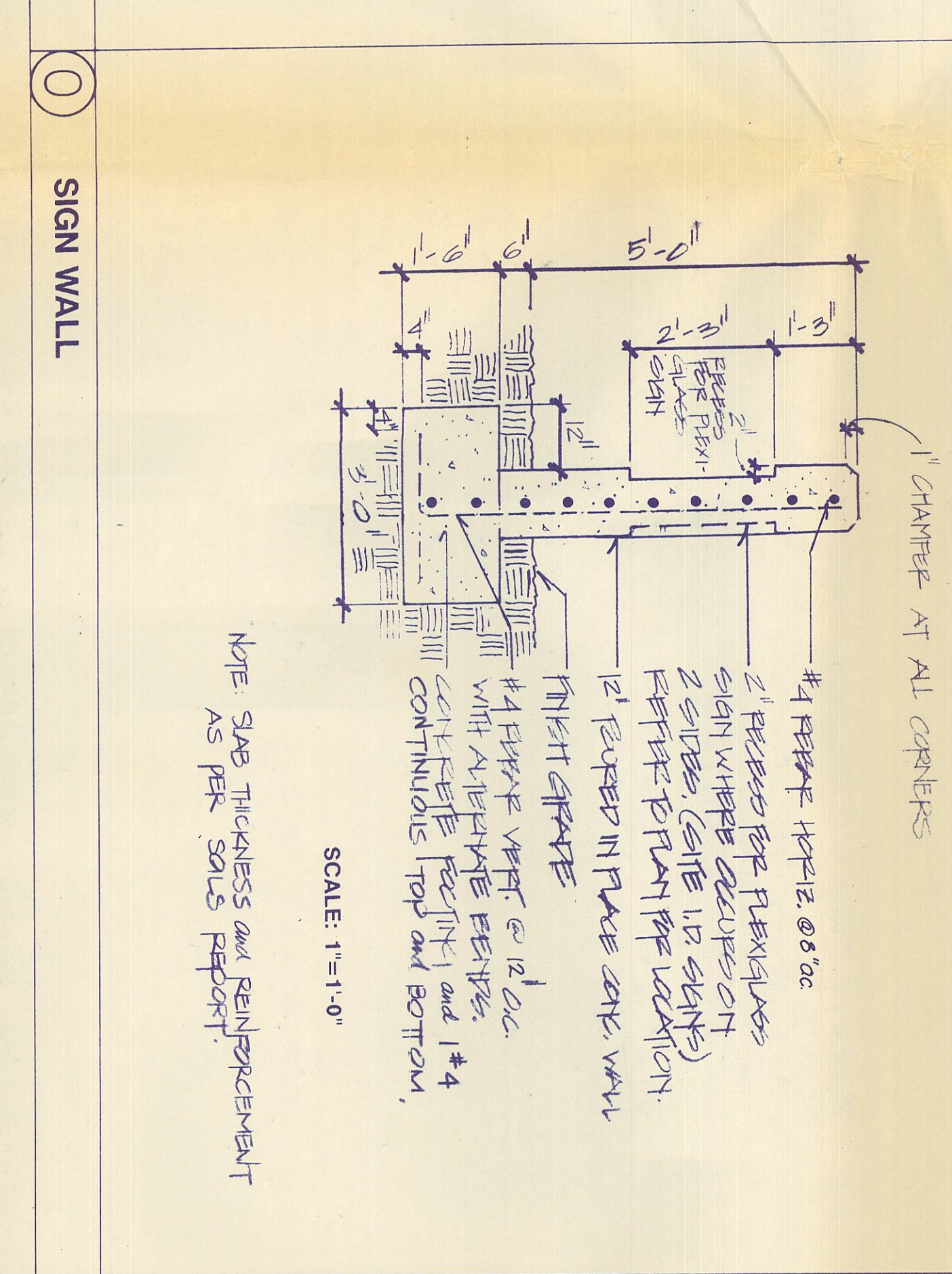
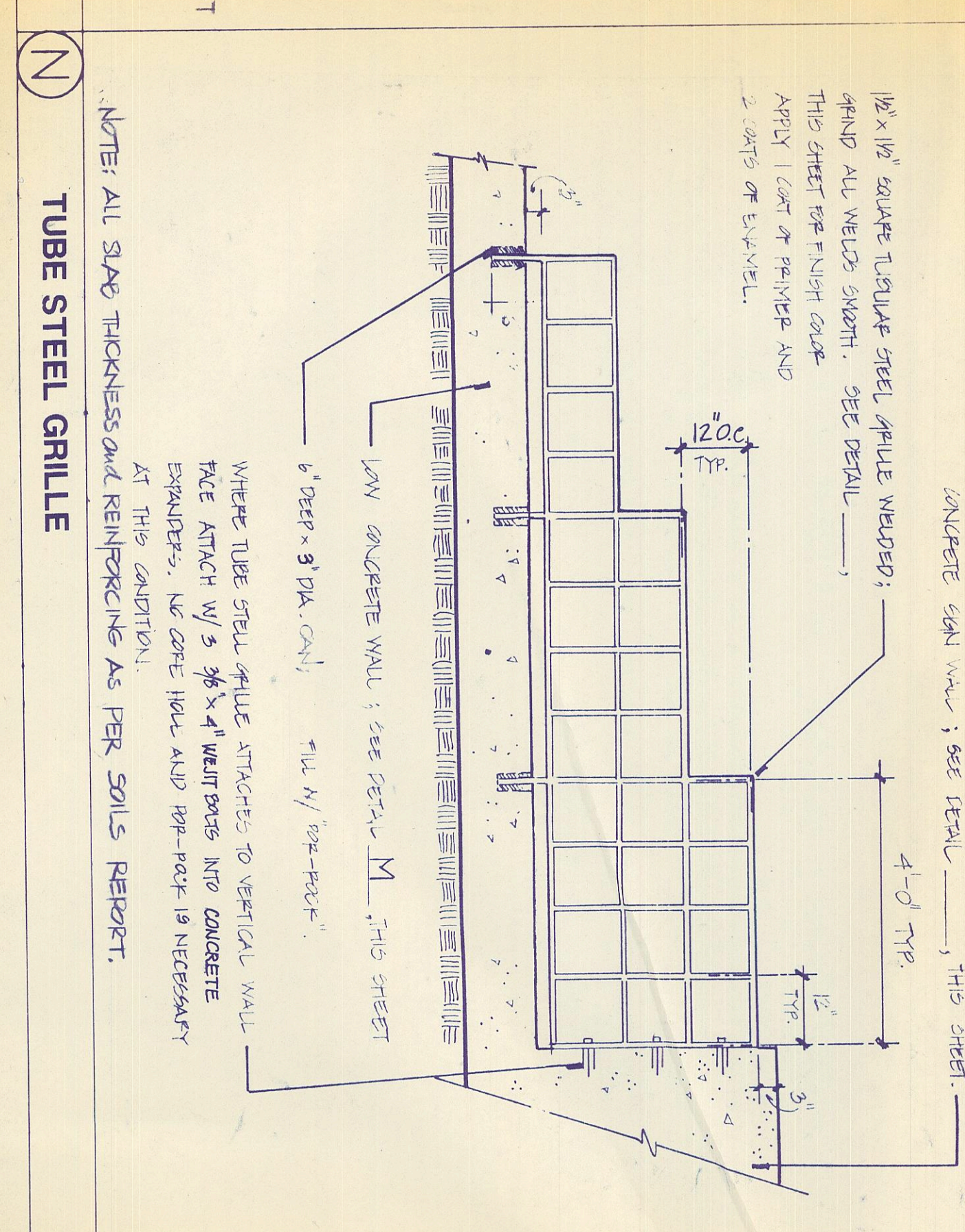
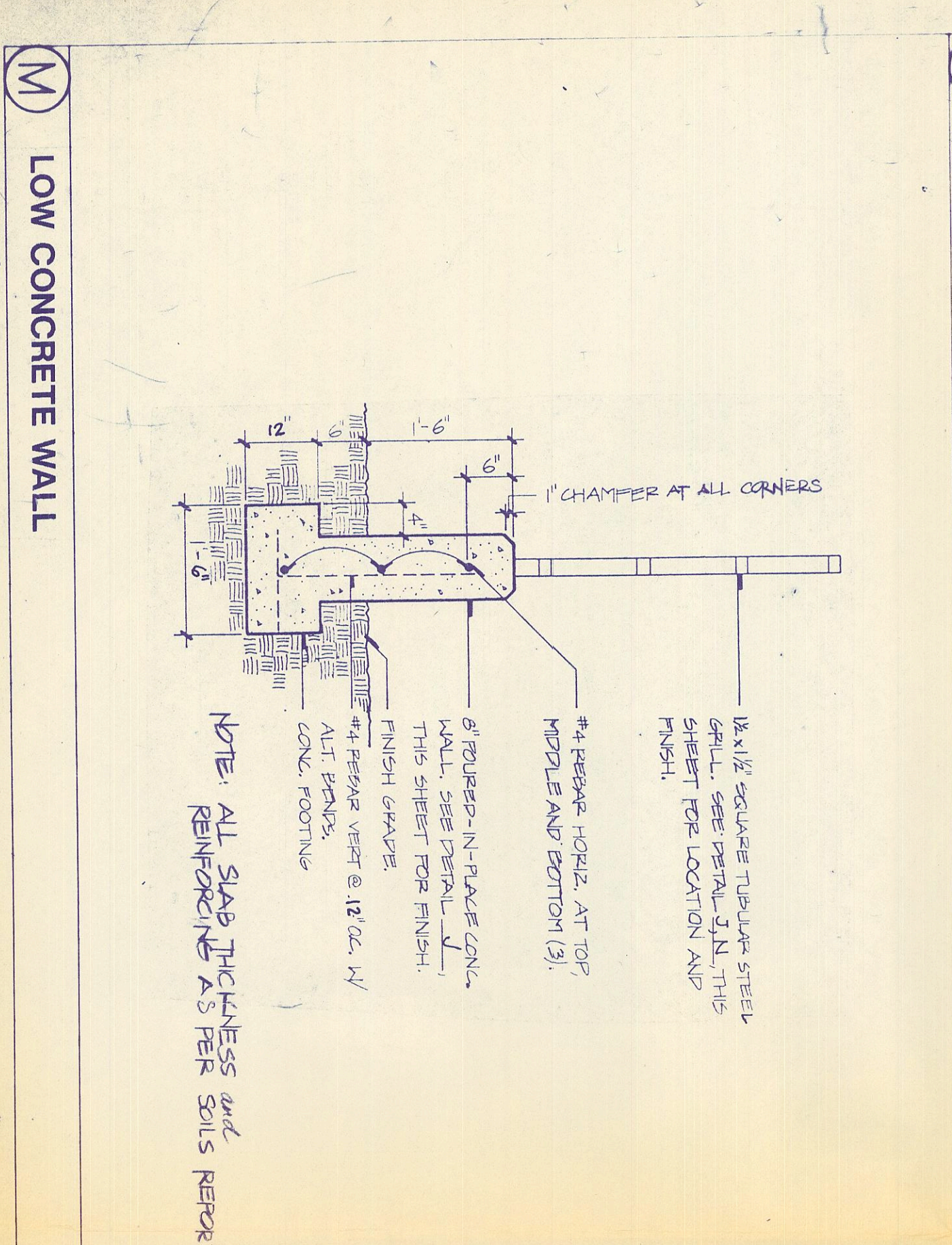
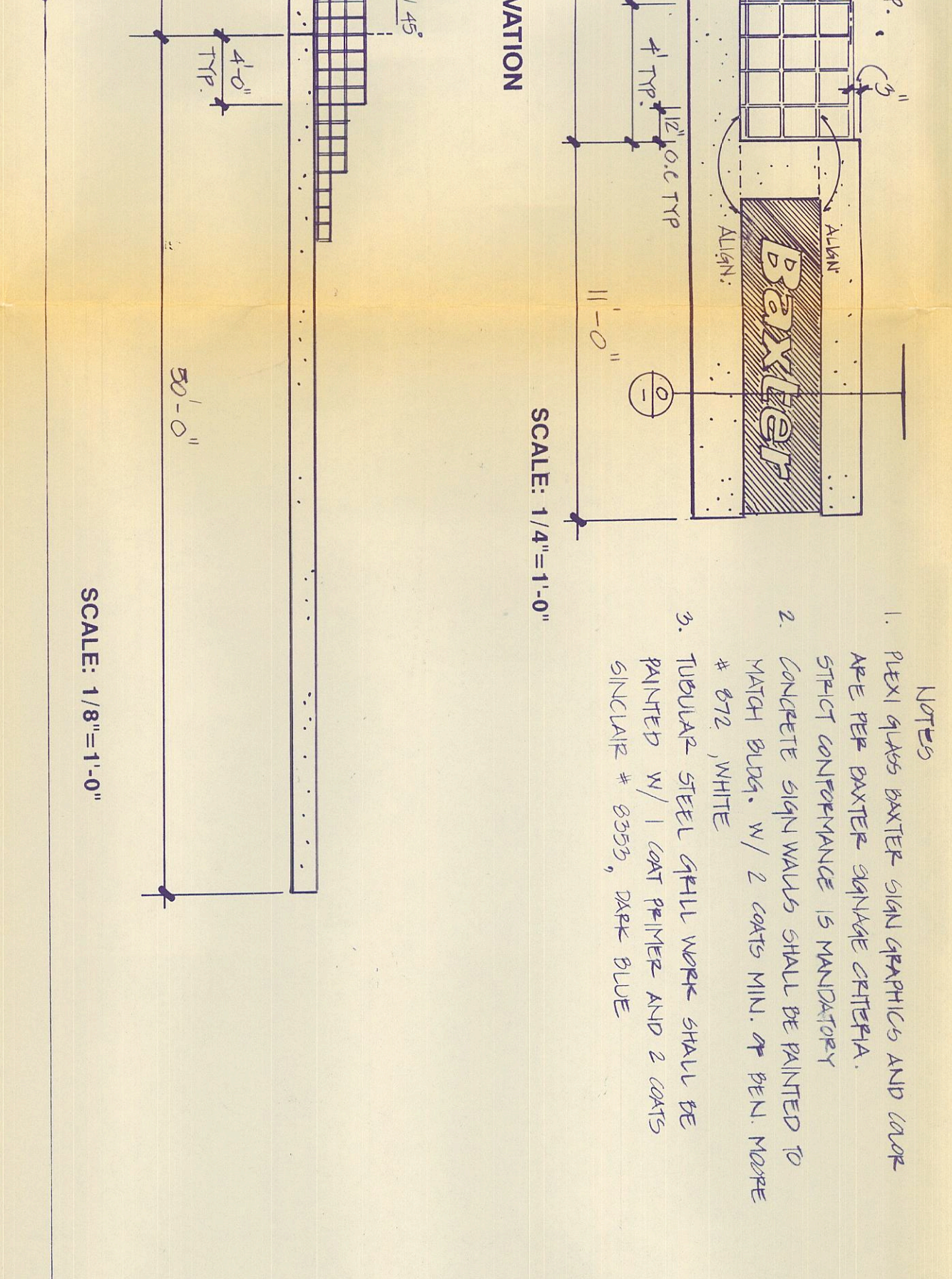
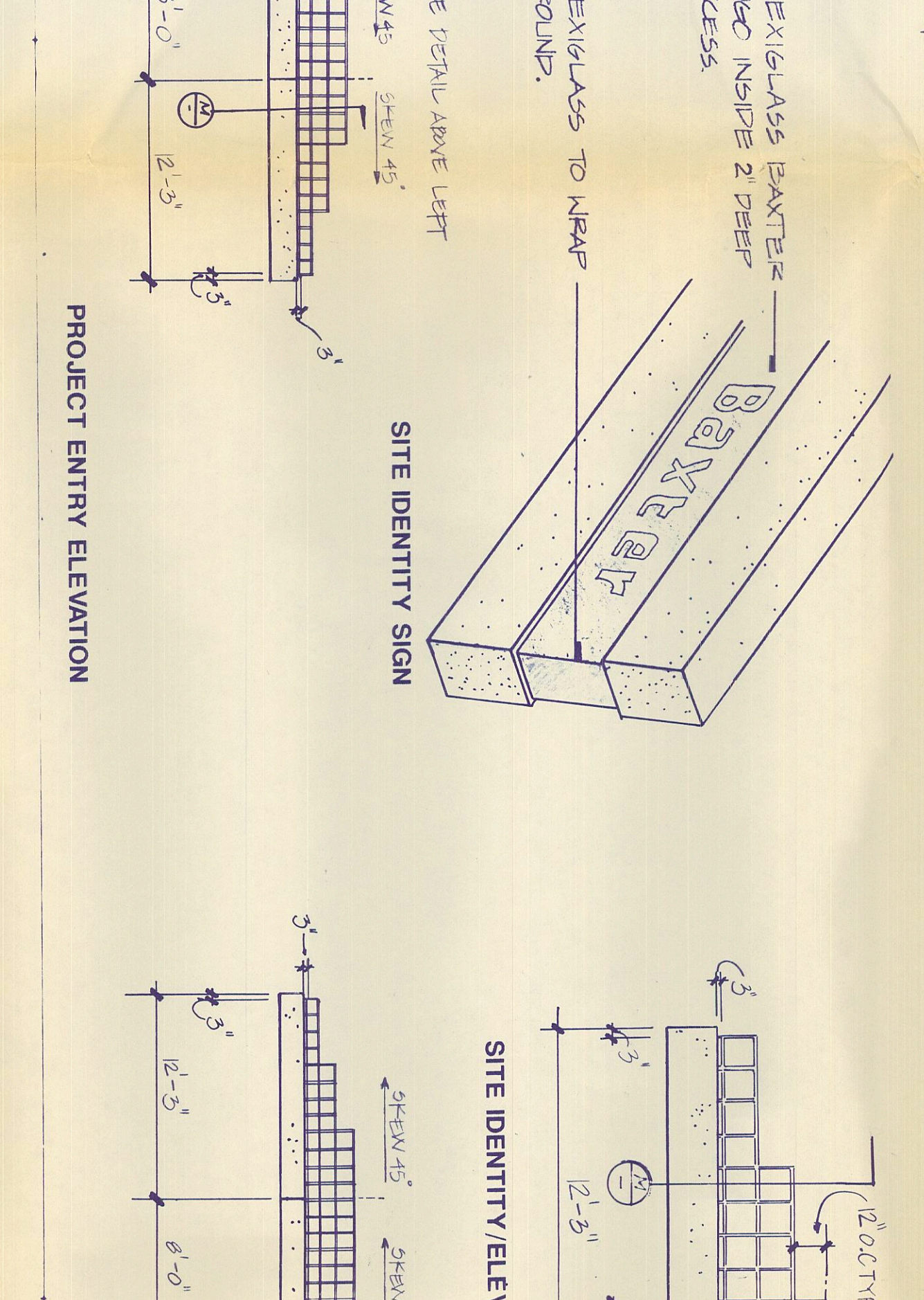
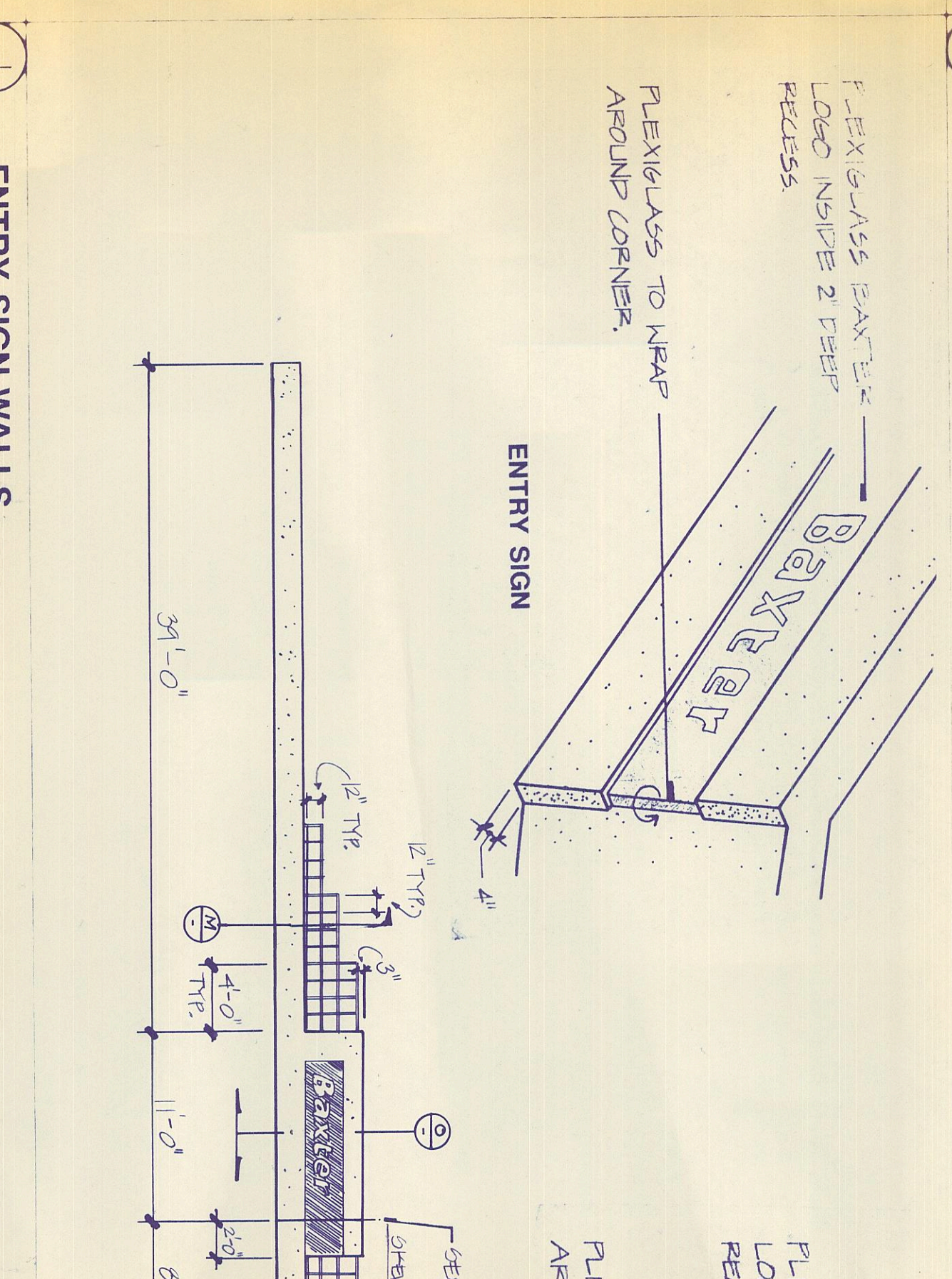
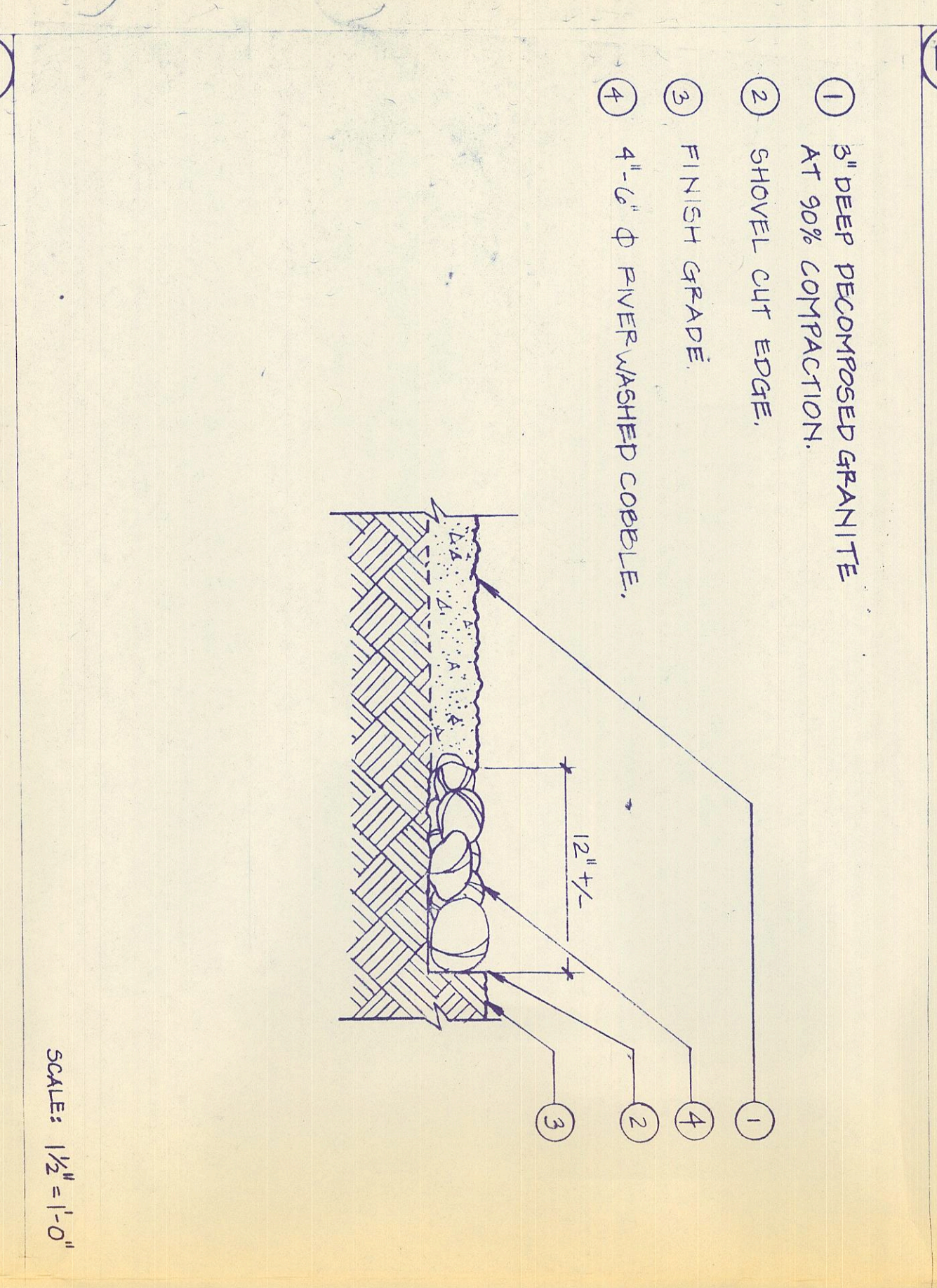
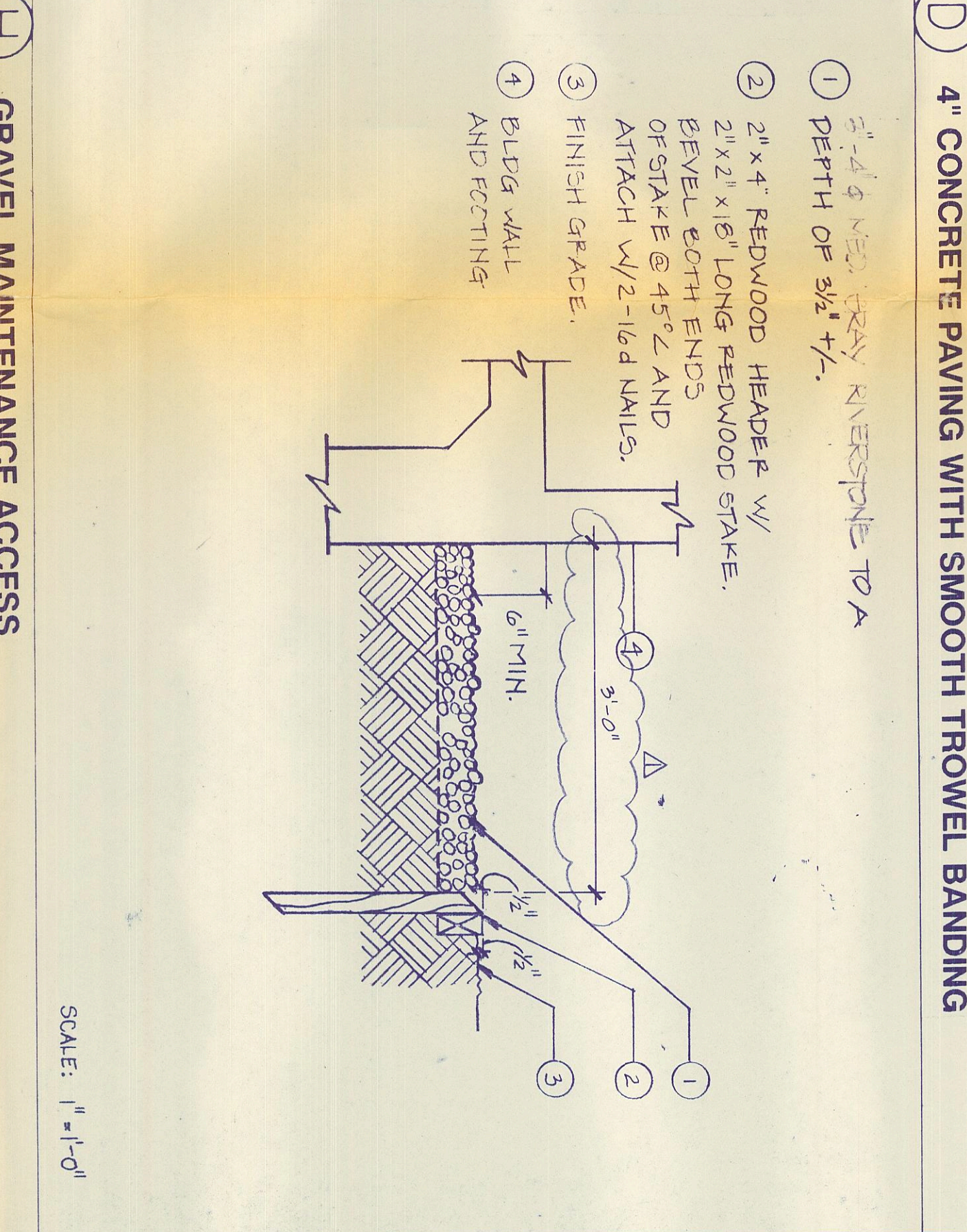
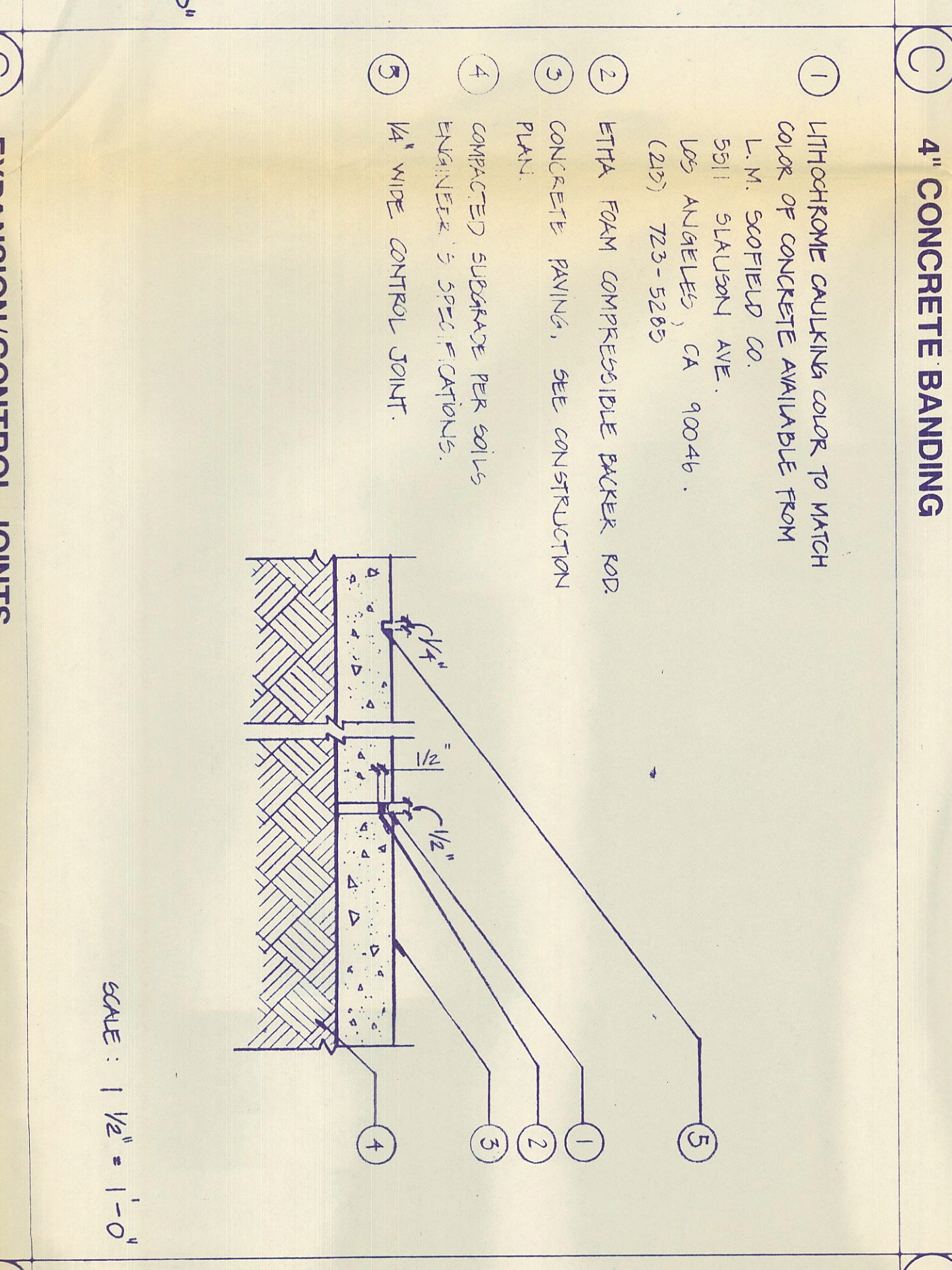
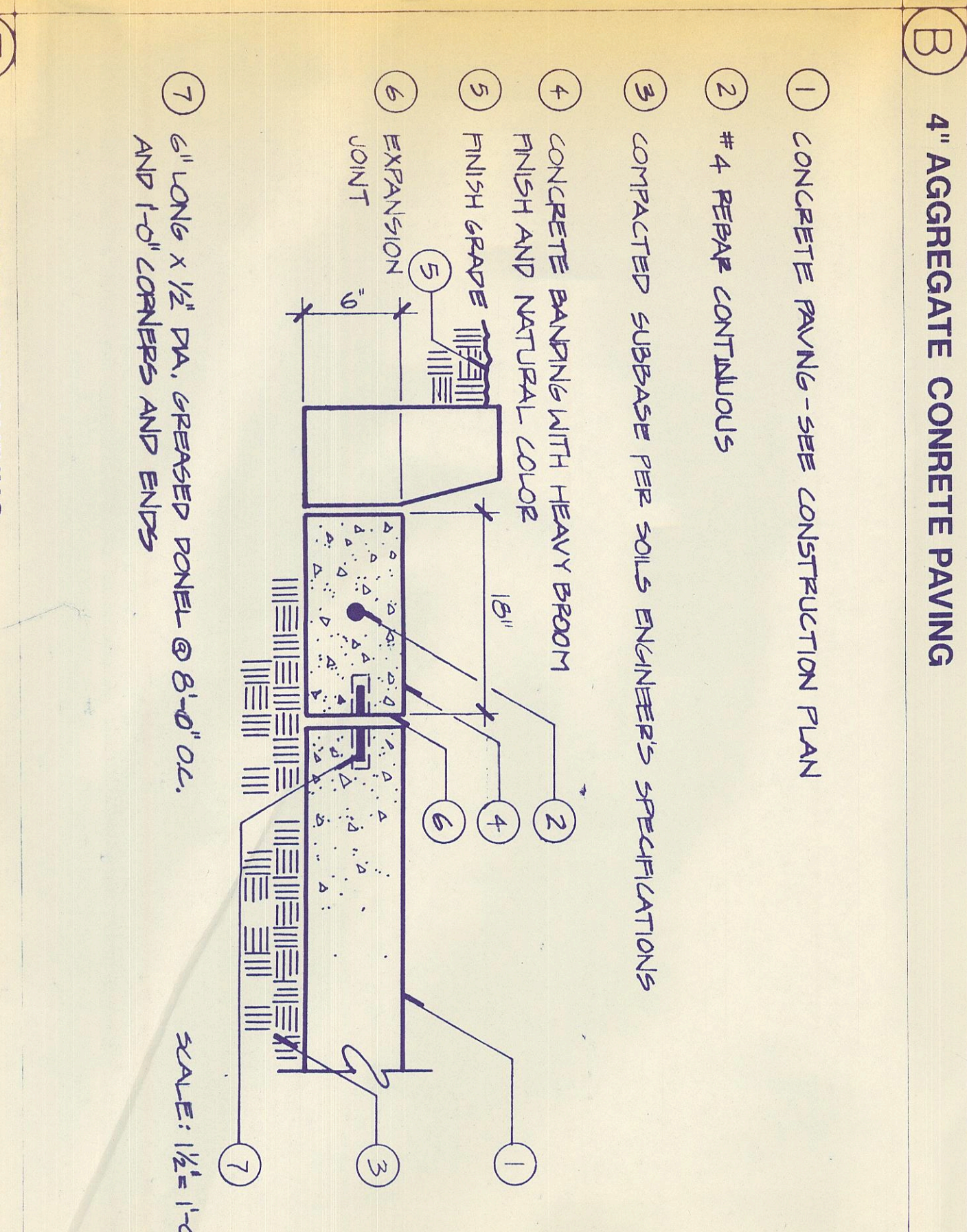
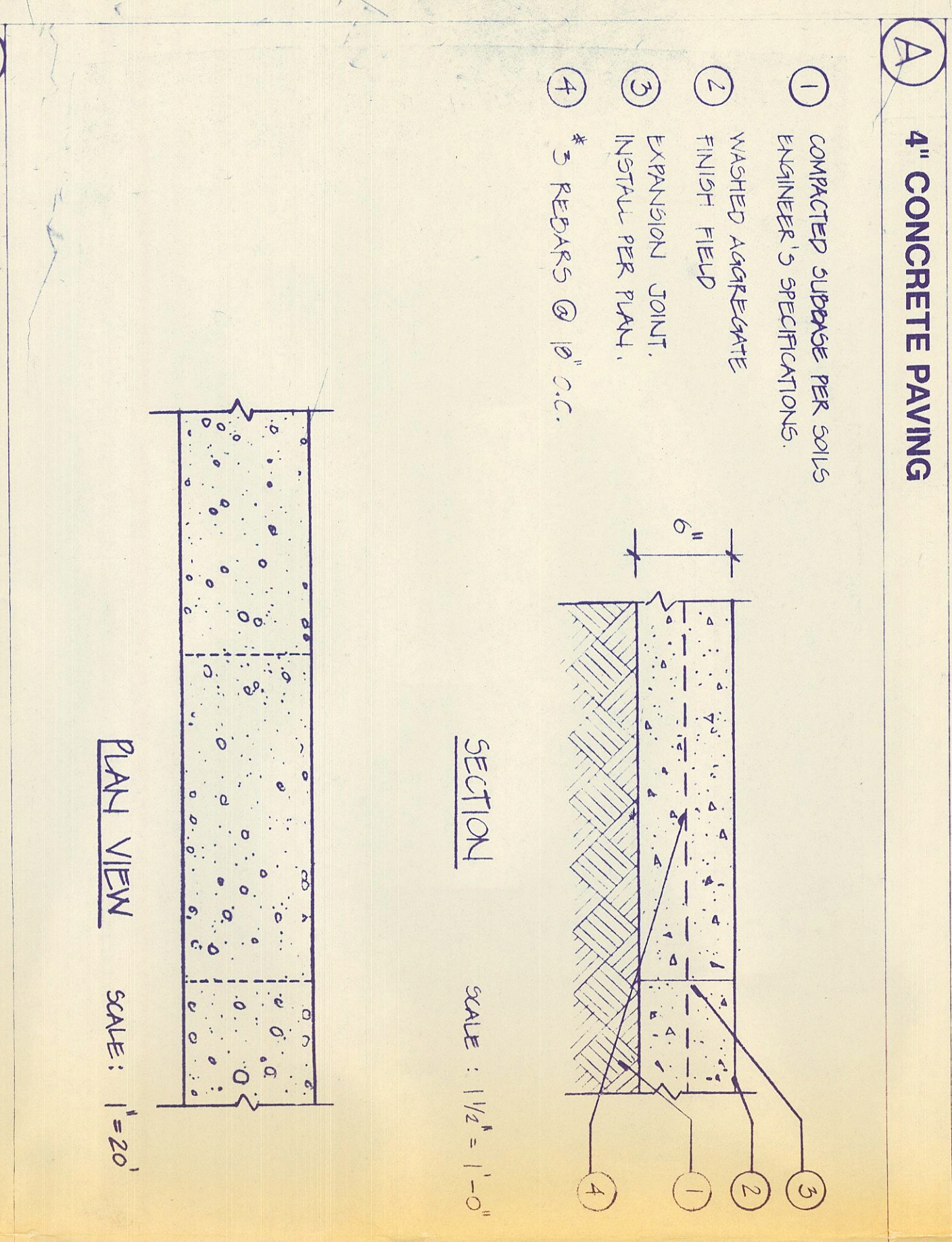
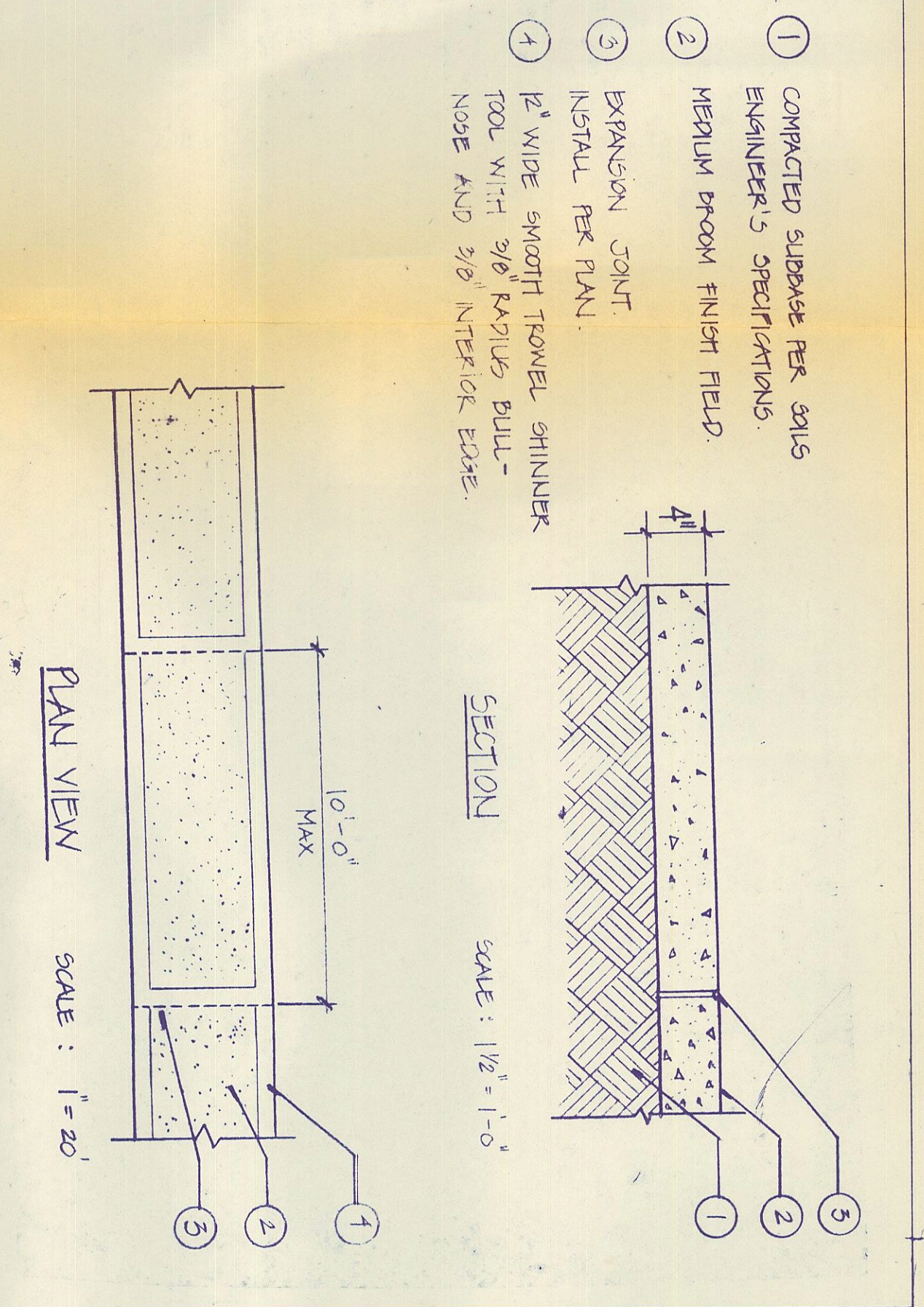
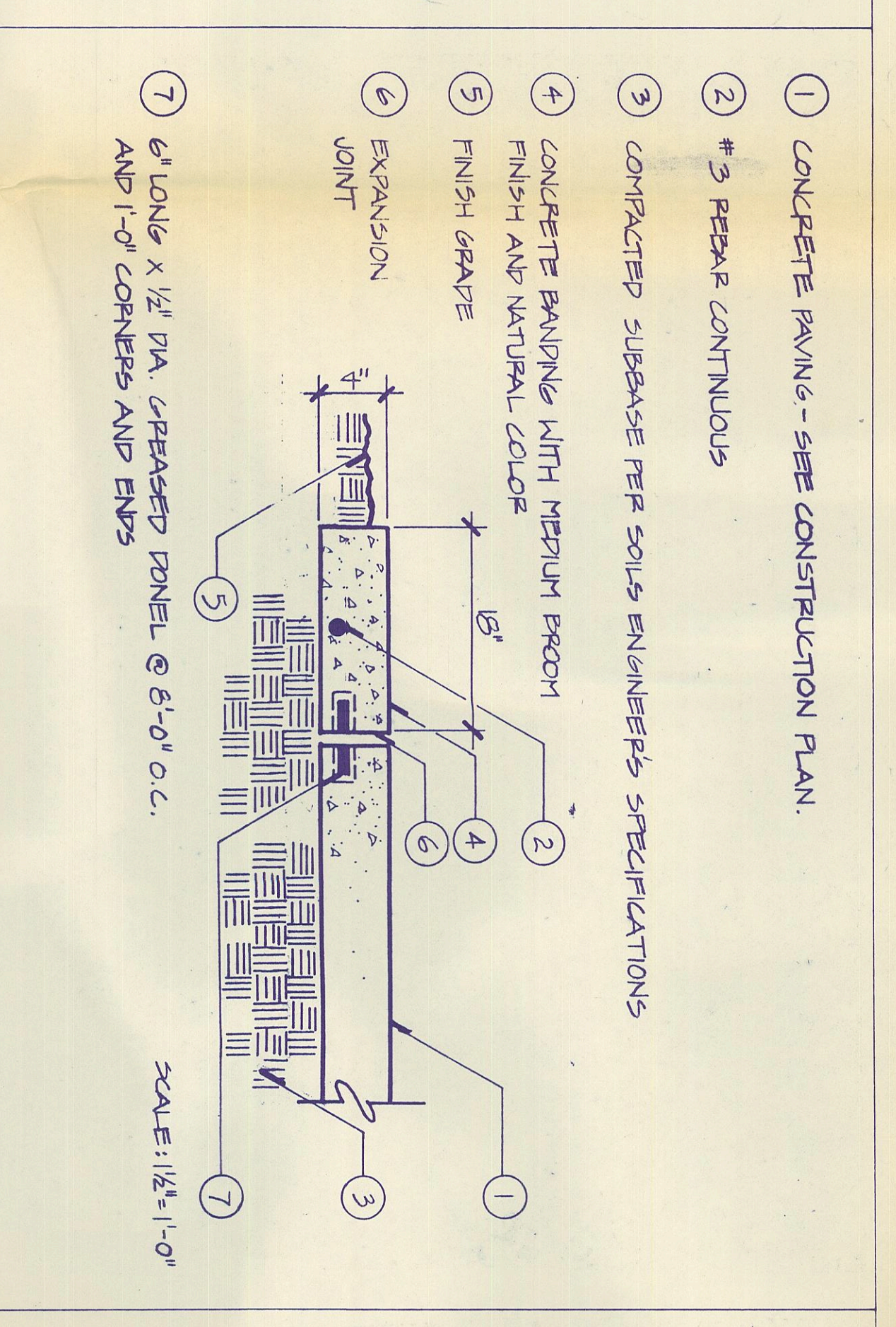
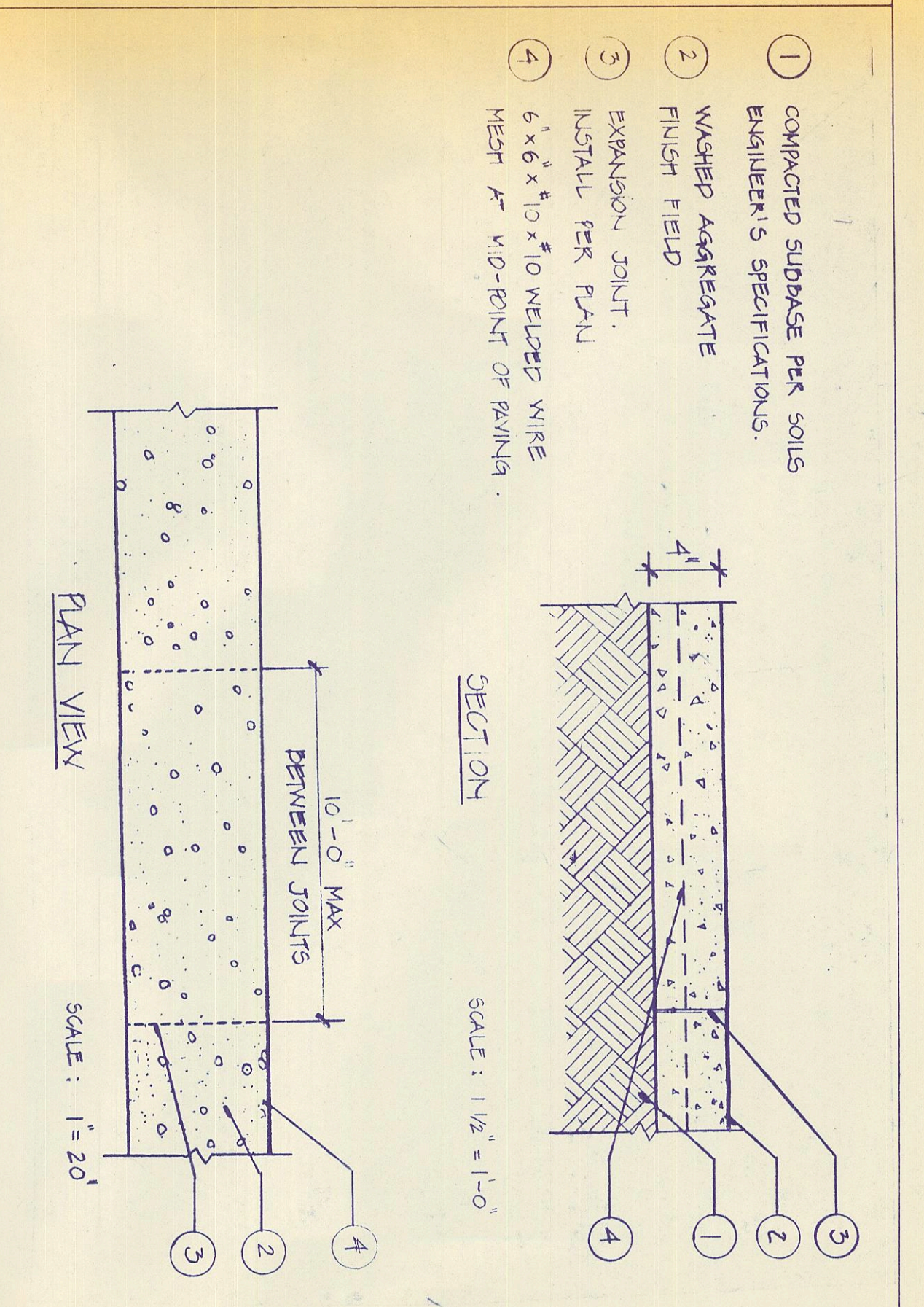
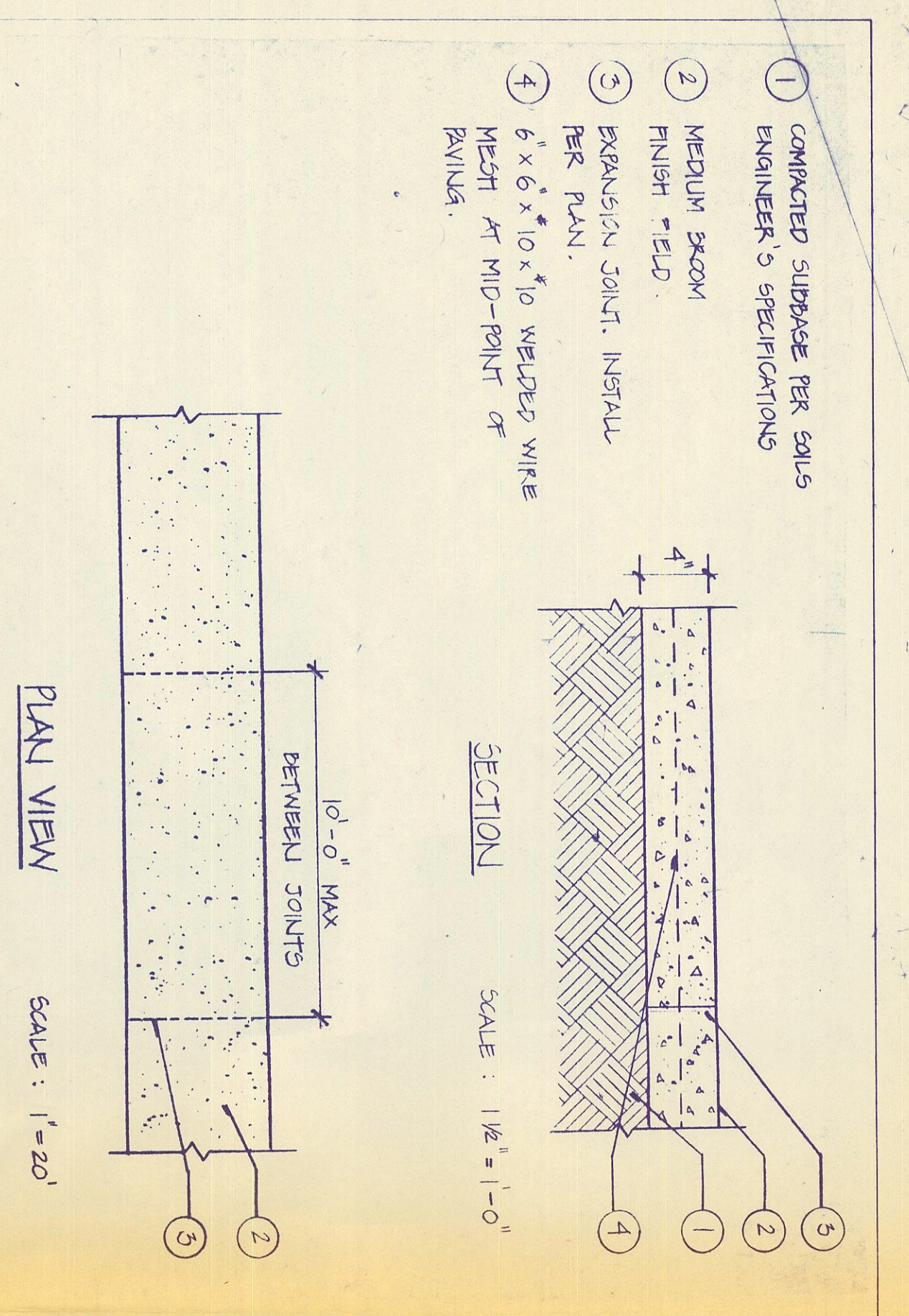



MATCHLINE SEE SHEET C1

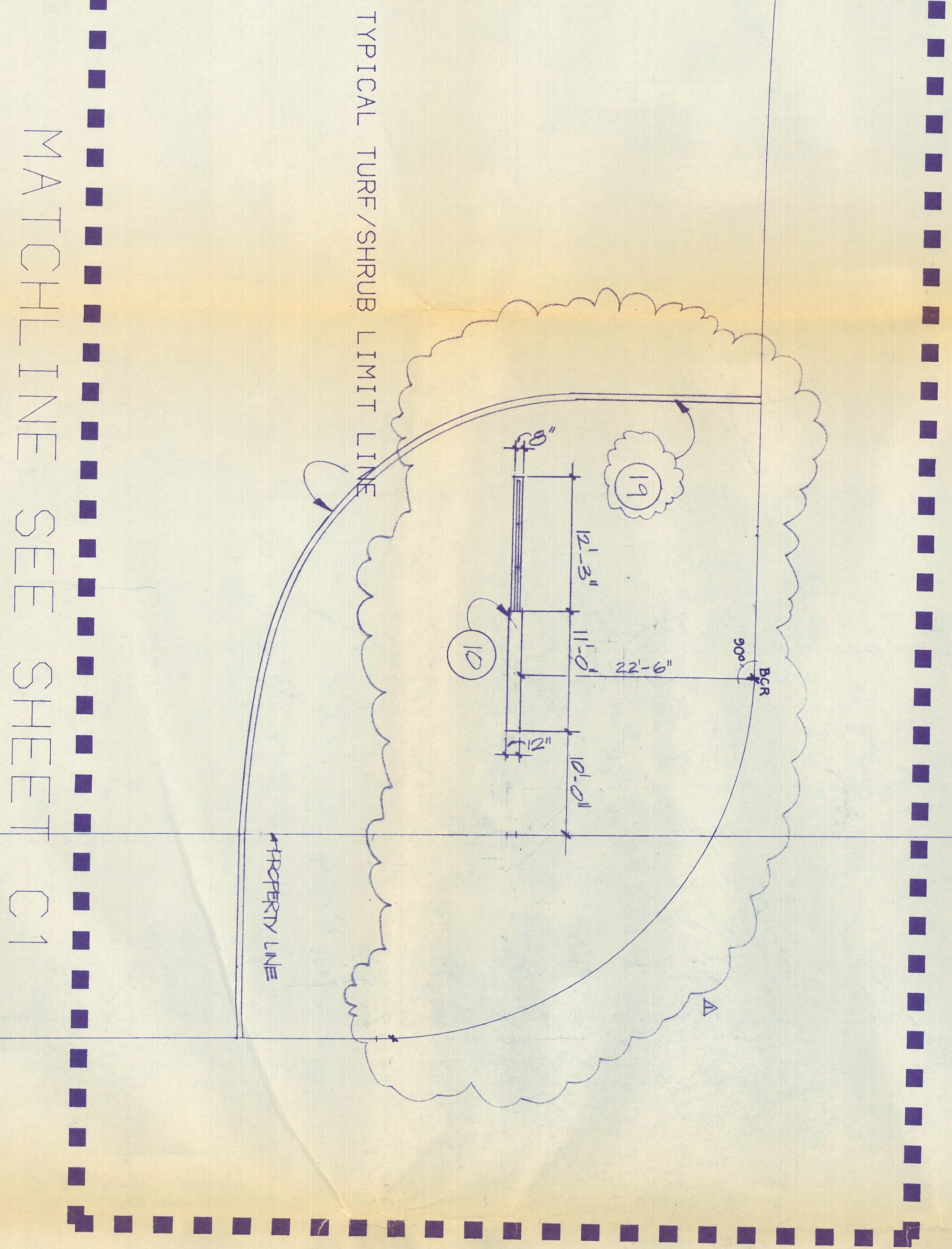
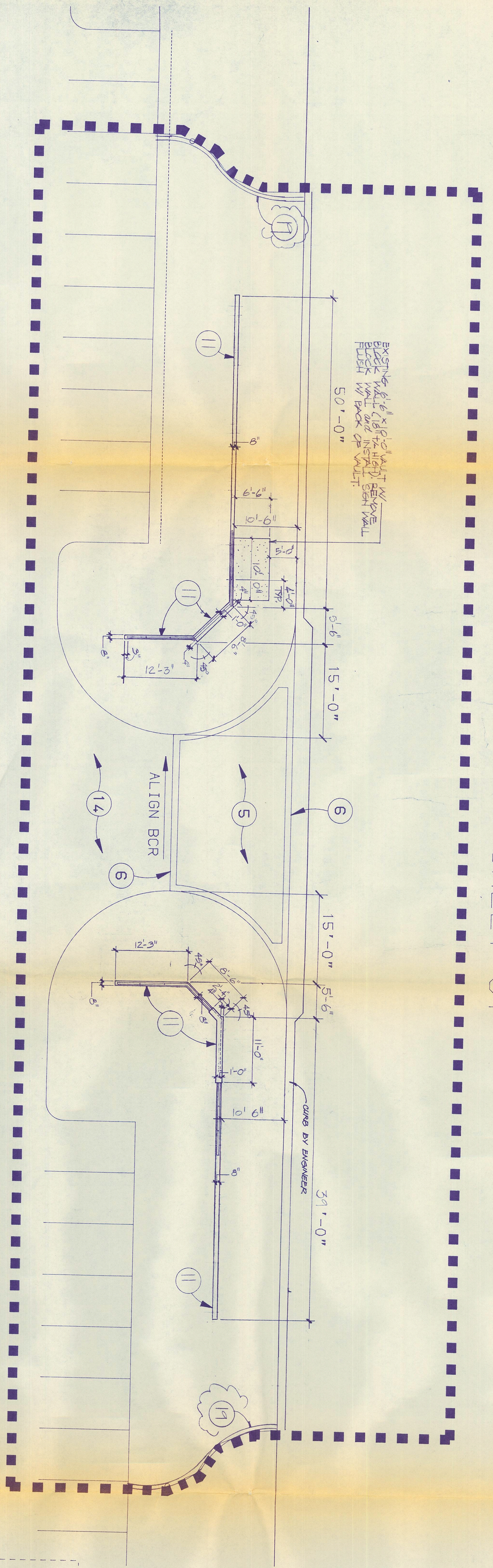

- CONSTRUCTION LEGEND**
- 1 INSTALL 4" THICK NATURAL COLORED CONCRETE PAVING WITH A MEDIUM BROOM FINISH PER DETAIL A, SHEET D-1
  - 2 INSTALL 4" THICK NATURAL COLORED CONCRETE PAVING WITH A WASHED AGGREGATE FINISH PER DETAIL B, SHEET D-1
  - 3 INSTALL 4" THICK AND 1/2" WIDE NATURAL COLORED CONCRETE BANDING PER DETAIL C, SHEET D-1
  - 4 INSTALL 4" THICK NATURAL COLORED CONCRETE PAVING WITH A REBOUND BROOM FINISH AND A 17" WIDE SMOOTH TROWEL BANDING PER DETAIL D, SHEET D-1
  - 5 INSTALL 4" THICK NATURAL COLORED CONCRETE PAVING WITH A WASHED AGGREGATE FINISH PER DETAIL E, SHEET D-1
  - 6 INSTALL 4" THICK NATURAL COLORED CONCRETE BANDING WITH A HEAVY BROOM FINISH PER DETAIL F, SHEET D-1
  - 7 INSTALL EXPANSION JOINTS AND CONTROL JOINTS PER DETAIL G, SHEET D-1
  - 8 GRAVEL MAINTENANCE ACCESS PER DETAIL H, SHEET D-1
  - 9 INSTALL XERISCAPE COBBLE AREA PER DETAIL I, SHEET D-1
  - 10 CONSTRUCT CONCRETE SIGN AND WALL PER DETAIL J, SHEET D-1
  - 11 CONSTRUCT CONCRETE SIGN, WALL AND TUBULAR STEEL FENCE PER DETAIL K, SHEET D-1
  - 12 INSTALL REDWOOD HEADER PER DETAIL L, SHEET D-2
  - 13 LIGHT BOLLARDS, REFER TO LIGHTING PLANS SHEETS L-3 AND L-4
  - 14 ASPHALT PAVING BY ASPHALT PAVING CONTRACTOR
  - 15 ELECTRICAL TRANSDUCER PARTS BY ELECTRICAL CONTRACTOR
  - 16 FIRETRUCK ACCESS ROAD PER CIVIL ENGINEER
  - 17 PUMP STATION BY ARCHITECT
  - 18 TUBE STEEL FENCE BY ARCHITECT
  - 19 CONCRETE WALK STRIP PER DETAIL M, SHEET D-1
  - 20 CONCRETE WALK STRIP PER DETAIL N, SHEET D-1
- SEE CONSTRUCTION NOTES AND LEGEND SHEET C-1

RECEIVED  
PLANNING DEPT  
JUN 12 1991  
OFFICE  
OF THE  
CITY CLERK

SCALE: 1/8" = 1'-0"



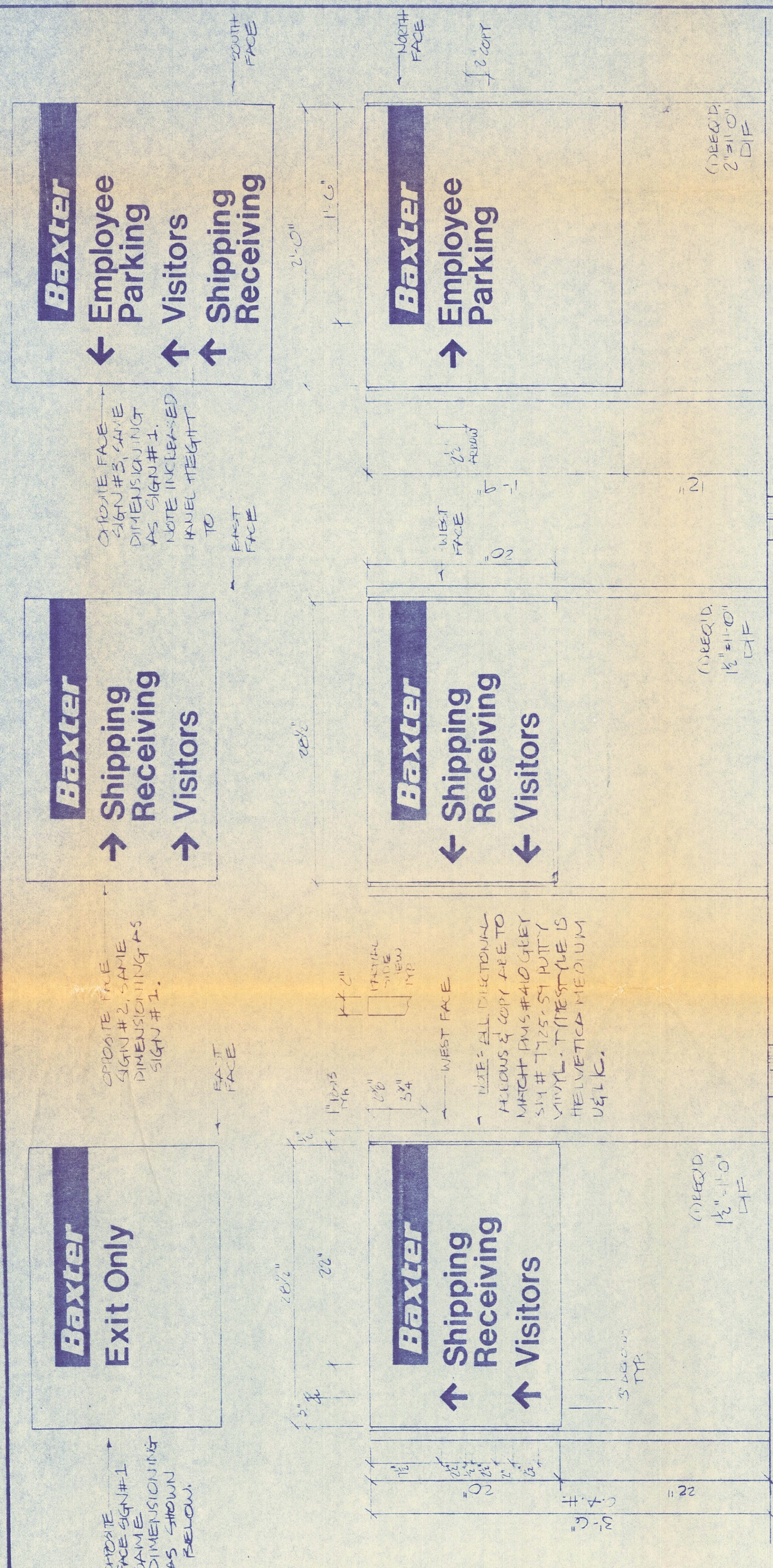

**1** (1) ONE 20" x 20" x 2" DEEP DOUBLE FACE NON-ILLUMINATED TWO FOLE DIRECTIONAL SIGN. EXTRUDED ALUMINUM RATS & PANEL OF FED 1-2-1 SYSTEM PAINTED BAXTER WHITE, W/ANDOTE #183 +-1 GLOSS WHITE. BAXTER BRAND IS COMPUTER CUT IN BAXTER BOARD BLUE 3M # 1125-17 VIVID BLUE CIRQUE W/WORDMARK TO SHOW THROUGH WHITE. ALL NON-VISUAL NON-COLOURIVE FAST EYES & INSTALLATION HARDWARE TO BE USED THROUGHOUT. SEE RPT PLAN FOR EXACT LOCATION OF SIGN.

**2** (1) ONE REQ'D, EXACT SAME SPECIFICATION AS SIGN #1  
NOTE: SEE PHOTOGRAPH PAGE FOR APPROXIMATE LOCATION OF THIS SIGN.

**3** (1) ONE REQ'D, 11-9" x 20" x 2" DEEP; EXACT SAME SPECIFICATION AS SIGN #1 WITH THE OVERSIZE PANEL AS NOTED ABOVE. SEE PHOTOGRAPH PAGE FOR APPROXIMATE LOCATION OF SIGN.

ORIGIN  
MATH  
S-1

FEDERAL SIGN  
Division Federal Signal Corporation

DESIGNED 5/2/91 DM	CUSTOMER AREA	DATE
CUSTOMER BAXTER HEALTH CARE	CUSTOMER ADDRESS	SIGN NO.
ADDRESS CNTRARIO, GA	DESIGN NO. MBLSH	DATE 3/25/91
DESIGN NO. 84 506	PROJECT NATIONAL	SHEET NO. 2 OF 6
SHEET ORDER NO.		

THIS SIGN IS THE PROPERTY OF FEDERAL SIGNAL CORPORATION. IT IS TO BE USED ONLY FOR THE PROJECT AND AT THE LOCATION SPECIFIED THEREON. IT IS TO BE RETURNED TO FEDERAL SIGNAL CORPORATION AT THE END OF THE PROJECT. FEDERAL SIGNAL CORPORATION IS NOT RESPONSIBLE FOR THE PROTECTION OF THIS SIGN FROM VANDALISM OR THEFT. FEDERAL SIGNAL CORPORATION IS NOT RESPONSIBLE FOR THE PROTECTION OF THIS SIGN FROM VANDALISM OR THEFT. FEDERAL SIGNAL CORPORATION IS NOT RESPONSIBLE FOR THE PROTECTION OF THIS SIGN FROM VANDALISM OR THEFT.







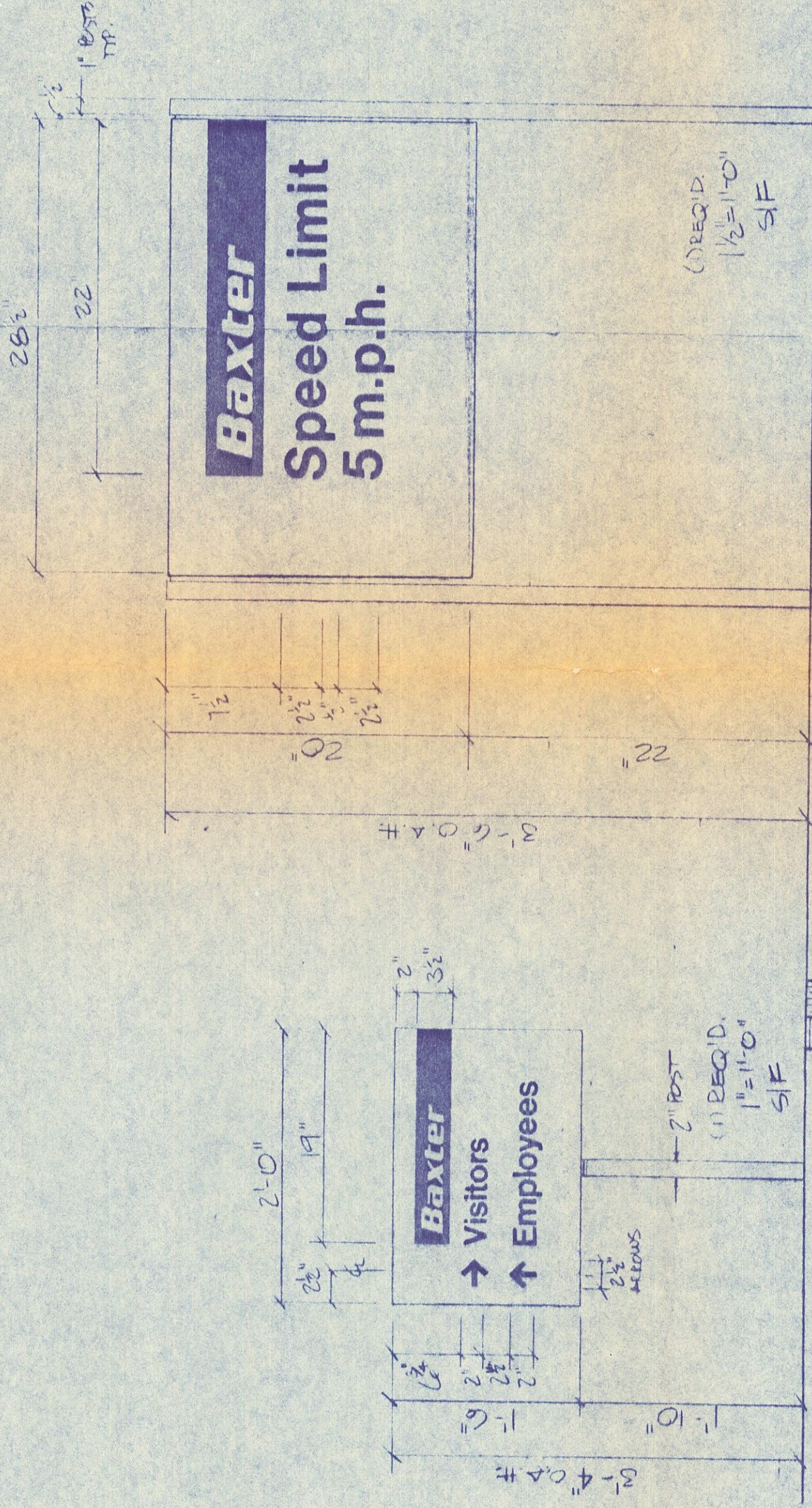

**7** (1), ONE 1'-6" X 2'-0" X 3'-4" O.A.H. X 2" DEEP SINGLE FACE, SINGLE POST NON-ILLUMINATED POST & PANEL DIRECTIONAL SIGN. ALL ALUMINUM CONSTRUCTION, POST & PANEL PAINTED 'BAXTER' WHITE, WYANDOTTE # 1B3 A-1 GLOSS WHITE. 'BAXTER' BAND IS COMPUTER CUT IN 'BAXTER' ROYAL BLUE, 3M # 1725-11 VIVID BLUE OPAQUE. WORDMARK TO SHOW THRU IN WHITE, COPY & ARROWS MATCH PMS # 410 GREY, 3M # 1725-59 PUITY VINYL IN HELVETICA MEDIUM WELK. ALL NON-VISIBLE NON-CORROSIVE FASTENERS & INSTALLATION HARDWARE TO BE USED THROUGHOUT SEE PLOT PLAN & PHOTOGRAPH PAGE FOR EXACT LOCATION OF SIGN.

**8** (1), ONE 20" X 28 1/2" X 2" DEEP SINGLE FACE NON-ILLUMINATED TWO ROLE DIRECTIONAL SIGN. EXTRUDED ALUMINUM POSTS & PANEL OF FED 1-2-1 SYSTEM PAINTED 'BAXTER' WHITE, WYANDOTTE # 1B3-A-1 GLOSS WHITE, 'BAXTER' BAND IS COMPUTER CUT IN 'BAXTER' ROYAL BLUE 3M # 1725-11 VIVID BLUE OPAQUE, WORDMARK TO SHOW THRU IN WHITE, ALL NON VISIBLE NON-CORROSIVE FASTENERS & INSTALLATION HARDWARE TO BE USED THROUGHOUT. SEE PLOT PLAN FOR EXACT LOCATION OF SIGN.

**9** (1), ONE SET 2" HIGH LOGO REGULAR CUT FOIL 1ST SURFACE APPLICATION WHITE WINDOW VINYL LOGO.

LOCATE ON RIGHT HAND GLASS DOOR AS DIMENSIONED ABOVE. SEE PHOTOGRAPH PAGE FOR LOCATION OF SIGN.

**S-3**  
OK 11/1/9

**FEDERAL SIGN**  
Division Federal Signal Corporation

REVISIONS	5/3/91 DM	CUSTOMER APPROVAL	DATE
CUSTOMER	BAXTER HEALTHCARE	ADDRESS	ONTARIO, GA
DESIGN NO.	B4504	DESIGNER	DM
SALES ORDER NO.		DATE	3/26/91
		SALESMAN	MOTISH
		DISTRICT	NATIONAL
		SCALE	NOTED
		SHEET	NO 4 of 6

Copyright by Federal Sign, Division Federal Signal Corporation. It is understood that the purchaser of this sign is to be responsible for its installation. It is recommended that the purchaser obtain a copy of the sign specifications and drawings for reference in the planning, construction or installation of the sign. The purchaser is to be responsible for the sign's location, size, and color. The purchaser is to be responsible for the sign's maintenance and repair. The purchaser is to be responsible for the sign's removal and disposal.



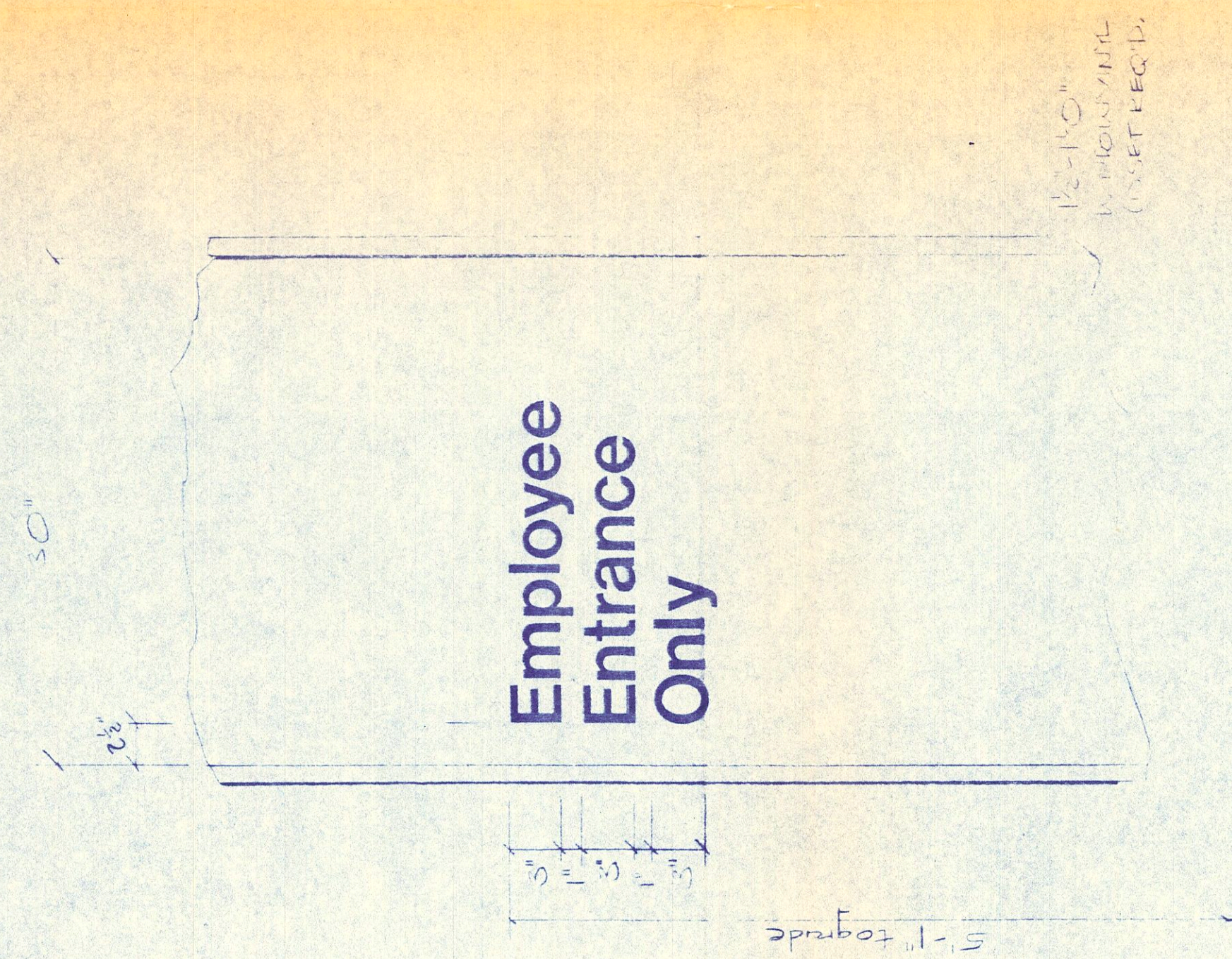

**10** (1) ONE SET 3" HIGH REGULAR CUT FOR LIST SURFACE APPLICATION WHITE WINDOW VINYL. TYPESTYLE IS HELVETIKA MEDIUM. LOCATE ON GLASS DOOR AS DIMENSIONED ABOVE. SEE PHOTOGRAPH PAGE FOR LOCATION OF VINYL.

1/2" HOLE  
IF NOT REQUIRED

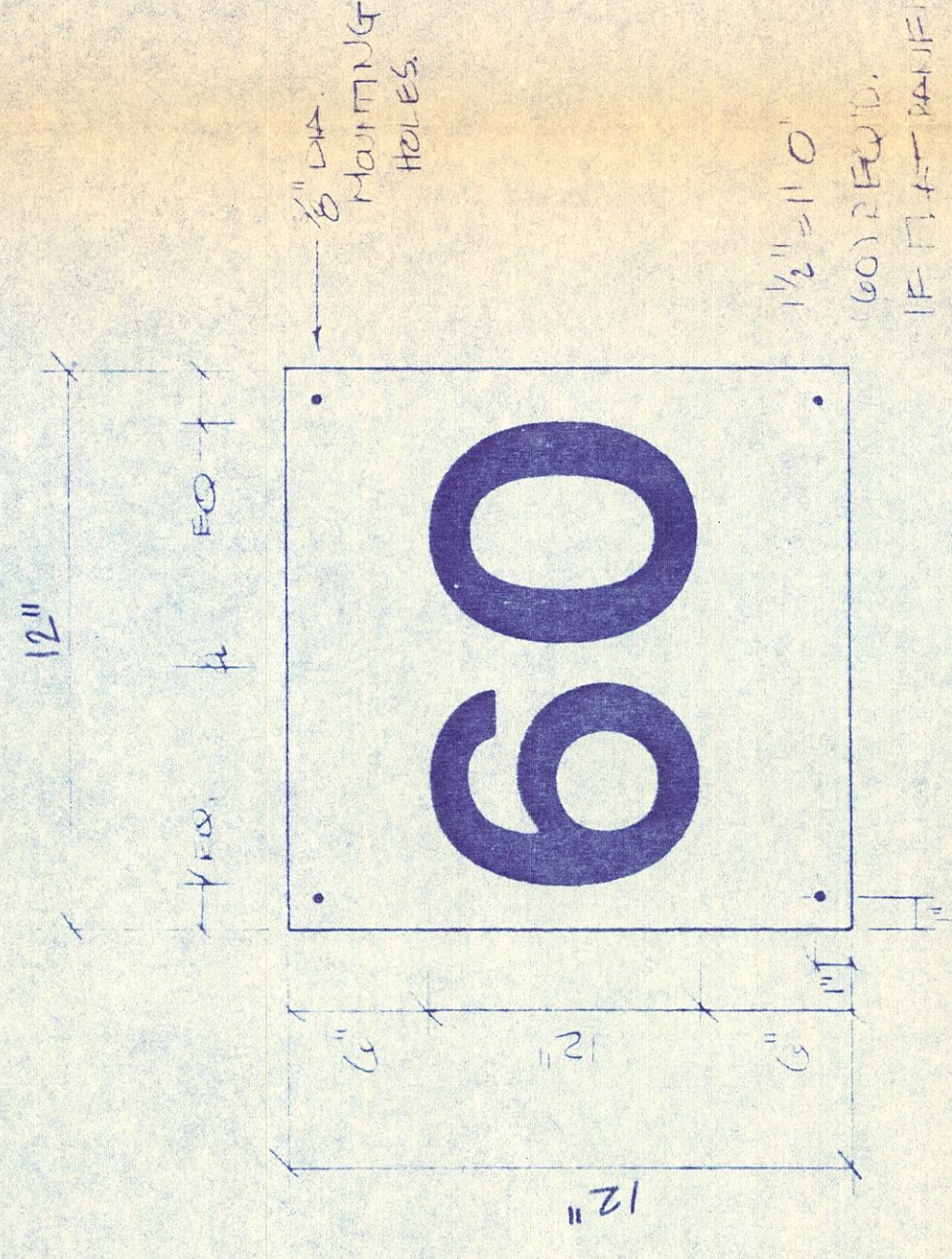

**11** (60) SIXTY, 1/2" THICK, 24" x 24" x 1/2" THICK FLAT ALUMINUM DOOR DOOR IDENTIFICATION PANELS. NUMERICAL TYPESTYLE IS HELVETIKA MEDIUM WHITE 2" HIGH COMPUTER CUT VINYL ON A FINISHED BAKELITE SIDE BACKGROUND. NO VINYL MOUNTING BACKGROUND IS ALLOWED IN ONE SIGN PER DOOR DOOR. SEE PHOTO PLAN & PHOTOGRAPH PAGE FOR LOCATION OF THESE SIGNS.

1/2" HOLE  
IF NOT REQUIRED

S-4  
OR  
VINYL

FEDERAL SIGN

Division Federal Signal Corporation

REVISED 5/3/91 DM	CUSTOMER APPROVAL	DATE
CUSTOMER: BAXTER HEALTHCARE		
ADDRESS: ONTARIO, GA	DESIGNER: DM	STATUS: NATIONAL
UTLIP NO: B4506	DATE: 3/26/91	
SHEET NO: 5		

Copyright by Federal Sign, Division Federal Signal Corporation. All rights reserved. This sign is the property of Federal Signal Corporation. It is not to be reproduced, copied, or used in any way without the written permission of Federal Signal Corporation. The design and appearance of this sign is the property of Federal Signal Corporation. It is not to be reproduced, copied, or used in any way without the written permission of Federal Signal Corporation.



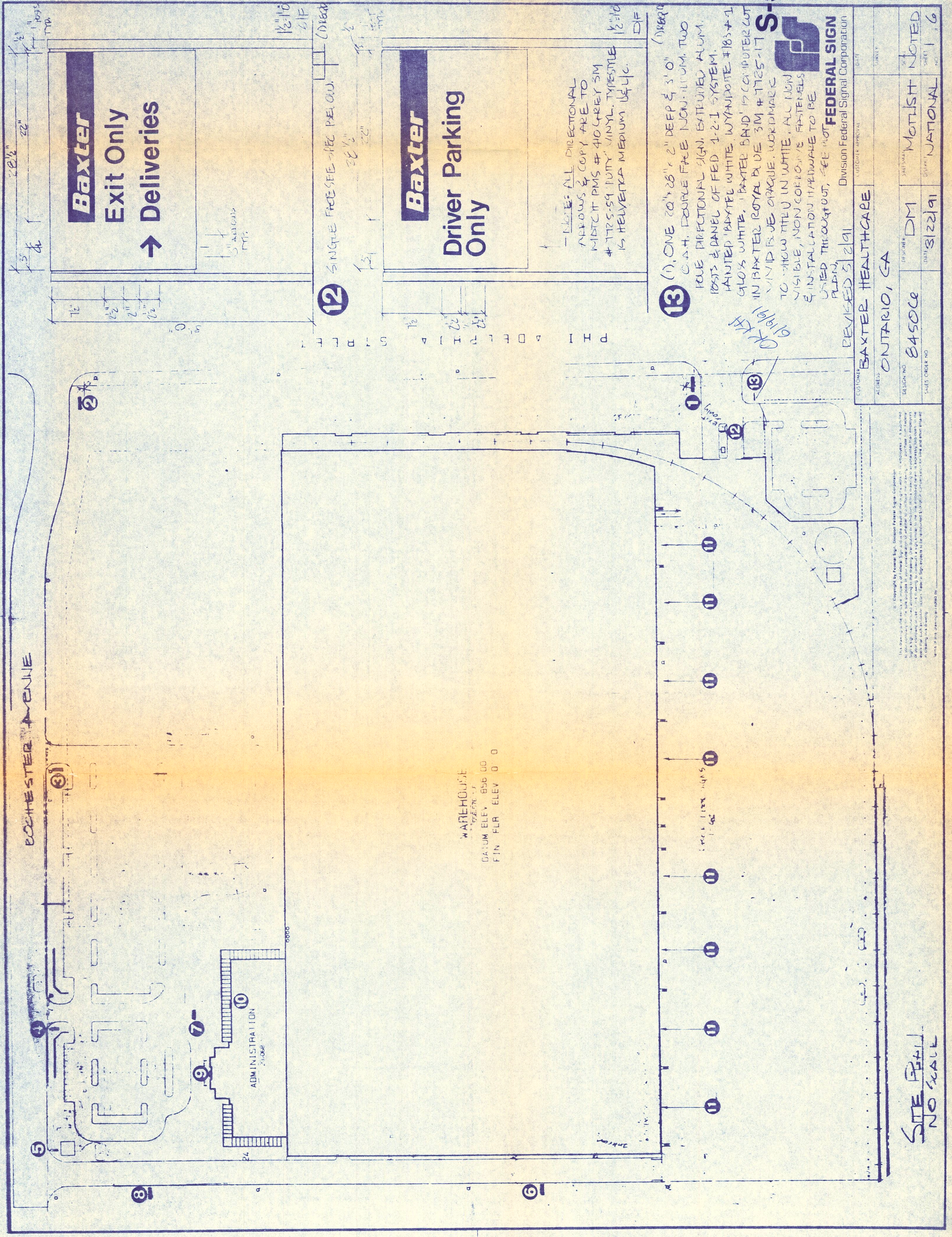

ALL DIRECTIONS  
 ALLOWED & COPY ARE TO  
 MATCH PMS # 410 GARY SIM  
 # 1725-59 DUTY VINYL TYPEFACE  
 IS HELVETICA MEDIUM 14/16

13 (1) ONE 20' x 28' x 2" DEEP x 3'0" HIGH  
 G.A. DOUBLE FACE NON-TITANIUM, TWO  
 TONE DIRECTIONS (SIGN) EXPOSED ALUM.  
 1893'S & PANEL OF FED. 1-21 SYSTEM.  
 PAINTED BAXTER WHITE. W/PAINT # 183+1  
 GLO'S WHITE. BAXTER BIRD 19 COMPUTER CUT  
 IN BAXTER ROYAL BLUE 3M # 1725-17  
 VIVID BLUE STROKE. WORKMARE  
 TO SHOW TITLE IN WHITE, ALL NON  
 VISIBLE, NON-CORROSIVE FINISHES  
 & INSTALLATION IT/ADWARE TO BE  
 UNTER THE OUTPOST, SEE NOT  
 PLAN

DESIGN NO.	DM	NOTED
SALES ORDER NO.	812191	NATIONAL
FEDERAL SIGN Division Federal Signal Corporation REVISED 5/2/91		
BAXTER HEALTHCARE ONTARIO, GA		

SITE PLAN  
 NO SCALE